



**AIPTEK®**

# POCKET DV II 1.3M

**LCD** DISPLAY

**INSTALLATION GUIDE**



# Contents

<b>Specifications</b>	1		
<b>Notice</b>	2		
<b>Bundled Accessories</b>	3		
<hr/>			
<b>Your Camera</b>	4		
• Camera Parts			
• Battery Installation	5		
• Strap			
• Tripod (Optional)	6		
• External Memory/ CF Card (Optional)			
<hr/>			
<b>Using your Camera</b>	7		
• How to Enter MENU on LCD Display	8		
• Mode Selecting	9		
• Focus	10		
• How to Hold your Camera	11		
<hr/>			
<b>Recording and Taking Pictures</b>	12		
• Voice Recording	13		
• Playback Movies, Still Pictures and Recorded Audio Files	14		
		• Image Resolution & Quality	15
		• AVI Movies, Still Pictures and Voice Recording Storage Capacity	16
		• Other Functions	18
		• Power	20
		• For Best Results	21
<hr/>			
		<b>A/V out Mode</b>	22
		• TV Playback	23
<hr/>			
		<b>Bundled Software</b>	24
		<b>Software Installation</b>	25
		<b>Hardware Installation</b>	26
<hr/>			
		<b>Downloading Files from Camera to Your PC</b>	29
		<b>Video Conference</b>	30
<hr/>			
		<b>Troubleshooting</b>	35
		<b>AIPTEK Service</b>	36



# Specifications



## System Requirements

- Microsoft Windows 98SE / 2000 / ME / XP
- Pentium II 266 MHz ( or equivalent )
- 64MB RAM (128MB RAM recommended)
- Video Card with 4 MB of RAM for minimum 16bit high color display.
- 4 X speed CD-ROM
- An available USB port
- Direct X8.0 or above



## Specifications

- Sensor Type 1.3M CMOS
- Effective Pixels 1.3M (1280x1024 pixels)
- Internal Memory 16MB built-in SDRAM  
( 6MB are available for capture,  
2M is Hardware Interpolated)
- External Memory Built-in CF Card Slot  
( Maximum : 512 MB )
- 1.4" 4,096 color STN LCD Display

## Main Functions

- Digital Video Camcorder :  
QVGA (320 x 240 pixels) / 10fps
- Digital Still Camera : 2Mega (1600x1200 pixels) /  
SXGA (1280 x 1024 pixels) /  
VGA (640 x 480 pixels)
- Video Conference :  
VGA ( 640 x 480 pixels ) / 10 fps  
QVGA ( 320 x 240 pixels ) / 24 fps  
QSIF ( 160 x 120 pixels ) / 30 fps
- Digital Voice Recorder : about 20 min. ( When not  
using CF Card)
- Supports AV output
- Focus Macro : 40cm
- Auto Exposure & Auto White-Balance
- Self Timer 10 - second Self Timer
- Power Saving Auto power off if idle over 60  
seconds
- Built-in Microphone & Speaker
- Battery: AA x 2 ( Alkaline)
- USB port
- Dimension : 3.3" x 2.7" x 1.6"



# Notice

1. Do not drop, puncture or disassemble the camera.
2. Remove batteries during long periods between use.
3. Avoid all contact with water and dry hands before using.
4. Do not expose the camera to high temperature or leave it in direct sunlight.
5. Avoid pressing hard on the camera body.

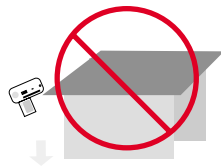

# Bundled Accessories



Camera



CD driver



User guide

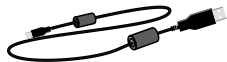

USB cable

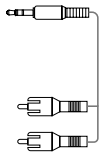

AV-out cable



2 x AA Alkaline batteries

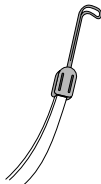

Strap



Tripod (Optional)



# Your Camera

## Camera Parts

- (1) Shutter
- (2) Lens
- (3) Focus
- (4) Mirror
- (5) Microphone
- (6) View finder
- (7) LCD display
- (8) LED light
- (9) Record button
- (10) MENU control
- (11) USB port
- (12) CF Card slot
- (13) AV-out port
- (14) Eject ( CF Card)
- (15) Strap-holder
- (16) Speaker
- (17) Battery cover
- (18) Tripod port
- (19) LCD Backlight control

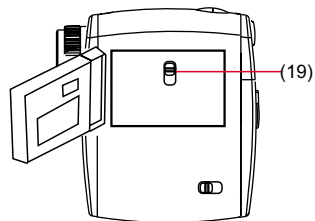
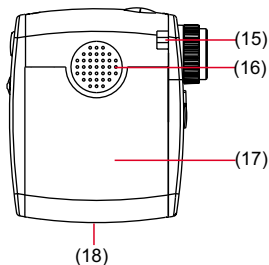
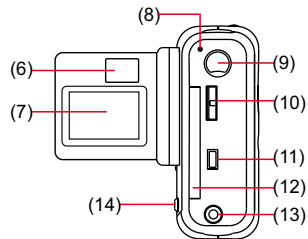
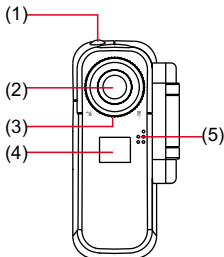

# Your Camera

## Battery Installation

Your camera runs on two AA alkaline batteries. High performance batteries are recommended for this camera for maximum battery life.

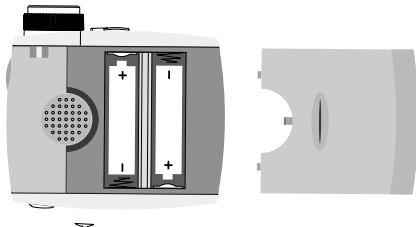

## Strap

Attach the carrying strap for convenience and safety.

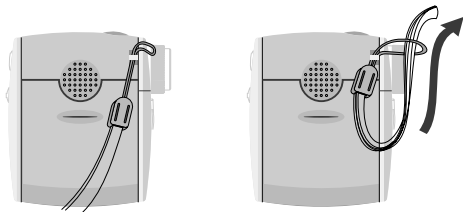



# Your Camera

## Tripod (Optional)

Use a tripod to minimize camera movement and ensure optimal image quality, especially while shooting longer movies, self-portraits or video conferencing.

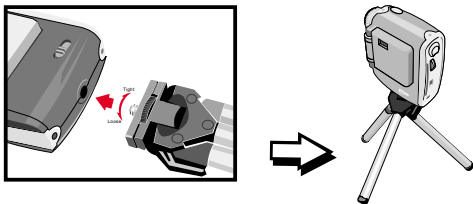

## External Memory/ CF Card (Optional)

In addition to 128 Mbits built-in SDRAM memory, your camera can store data on Compact Flash Cards ( 8MB-512MB). Insert you CF Card as shown. Files will be automatically stored on the CF Card after you've inserted the CF Card.

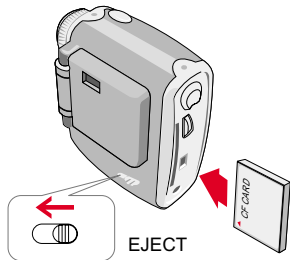

# Using Your Camera

## Opening LCD panel

Swing the LCD panel 90 ° away from the camera body. Be careful not to over extend the panel.

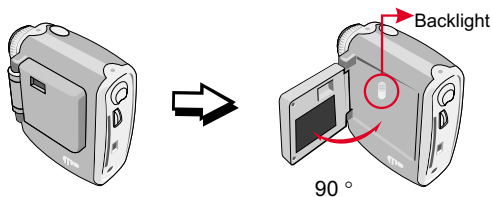

## Turning on/off your camera

Press and hold the MENU control for 3 seconds to turn on your camera.



- Manual shut-off: press the MENU control for 3 seconds. If you can't turn off your camera, please make sure you exit the MENU.
- Auto shut-off: your camera will automatically shut off after 60 seconds of inactivity.

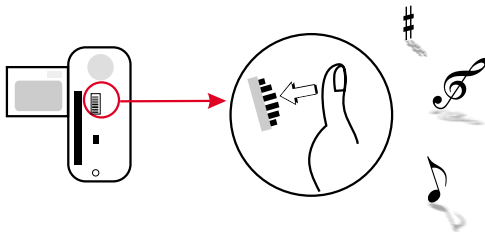

## How to Enter MENU on LCD Display

### Show MENU

After turning on the camera, press MENU control to show MENU. To exit MENU, select  on LCD display. See **Mode Selecting**.

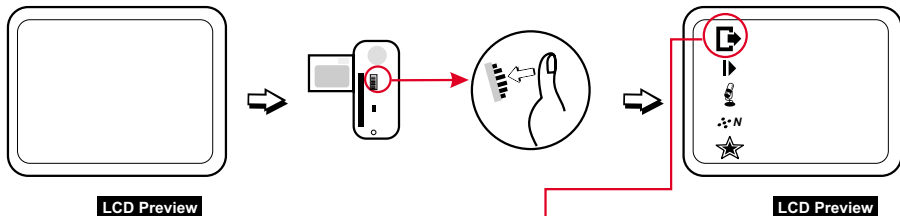



#### Note





Still picture mode and AVI Movie function are temporarily disabled when the MENU is shown. To take still pictures or AVI Movie, please select  to exit MENU.

# Mode Selecting

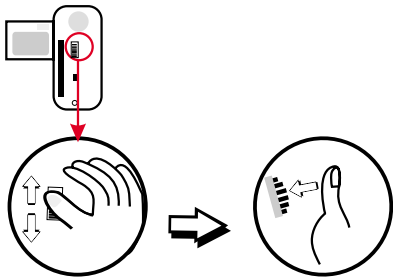
## Mode Selecting

Rotate  (MENU control) up or down to shift between modes. Press  to select mode.

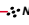



- (1) Exit MENU 
- (2) Playback 
- (3) Voice Record 
- (4) Picture Resolution 
- (5) Picture Quality 

**LCD Preview**

Screen Page 1



- (6) Self-Timer 
- (7) Erase All 
- (8) Format CF card 

**LCD Preview**

Screen Page 2

- (9) Battery Indicator 

## Focus

### Focus

Set focus before taking pictures.

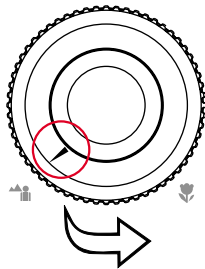

40"~∞ (100cm~∞)

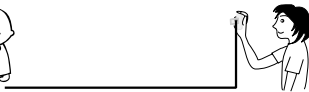



16"~40" (40cm~100cm)

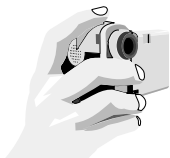

## How to Hold your Camera

### How to hold your camera



 Do not cover the lens.

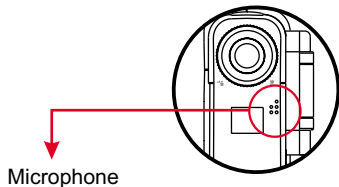

 Do not cover the microphone.

### Proper Distance between the camera and your eyes

With this proper distance when using the viewfinder to take pictures, subjects in the viewfinder would be clear.

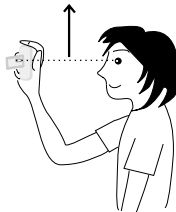

**20cm~40cm**



# Recording and Taking Pictures

Please turn on the camera first.

## To Record AVI Movies

- (1) Press and release  to record.
- (2) Flashing LED light indicates recording in progress.
- (3) Press and release  again to stop recording.

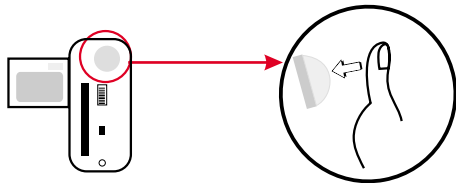



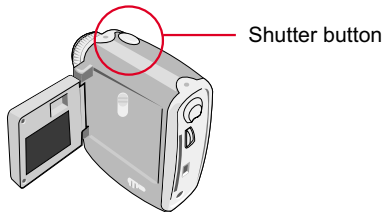

## Still pictures

- (1) Center the target in the viewfinder.
- (2) Press the shutter button.
- (3) After LED light stops, image is successfully captured.



## Voice Recording

### Voice Recording

- (1) Rotate  (MENU control) to highlight  and press  to start voice recording.
- (2) LED light indicates voice is being recorded.
- (3) Speak directly into the microphone.
- (4) Press  to stop voice recording.

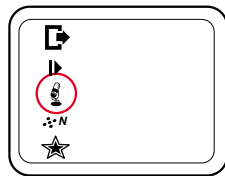

LCD Preview

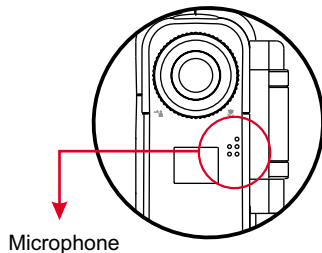









## Playback Movies, Still Pictures and Recorded Audio Files

Select  to playback movies, still pictures and recorded audio files. (See Fig.1)

● Steps:

- (1) Rotate  (MENU control) to highlight .
- (2) Press  and you enter thumbnail mode.
- (3) Rotate  to shift between thumbnails.
- (4) Press  to playback files.



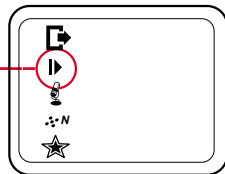

- To return to thumbnail mode from full screen playback, press .
- To return to LCD preview from thumbnail mode, press  (Record button).



"Playback" icon

LCD Preview Fig.1

- Press  to playback files.
- \* (Erase one)  
Press the shutter button twice to erase thumbnail. 

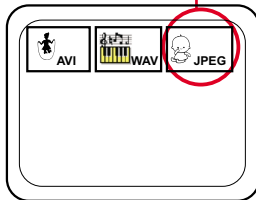

Thumbnail mode Fig.2

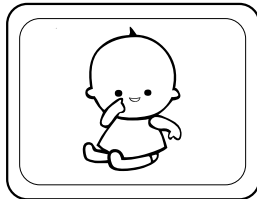

Playback thumbnail Fig.3

















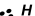

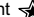
# Image Resolution & Quality

## Image resolution & quality

Three kinds of resolution and two kinds of quality are available for still image:

### ● Steps

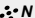
- (1) Rotate  (MENU control) to highlight ,  or .
- (2) Press  to select ,  or .
- (3) Rotate  to highlight  or .
- (4) Press  to select  or .
- (5) Press shutter to take pictures.

Resolution	
 <i>H</i>	= 2 Mega resolution
 <i>N</i>	= 1.3 Mega resolution
 <i>L</i>	= VGA resolution

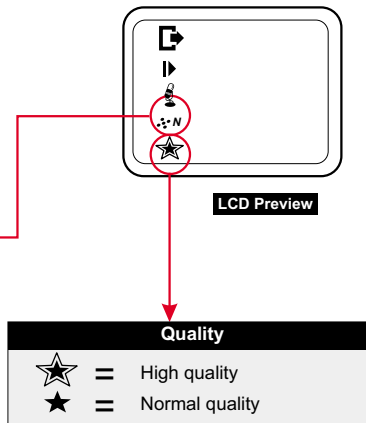

## AVI Movies, Still Pictures and Voice Recording Storage Capacity





### AVI Movies Storage Capacity

Your movies are stored as AVI files. Image size is 320x240 pixels, with frame rate 10 fps. Maximum recording time is determined by the capacity of your CF Card and your built-in SDRAM memory.

Built-in Memory	Estimated maximum recording time
Built-in SDRAM Memory	About 1.5 min
CF Card Storage Capacity	Estimated maximum recording time
16MB	About 2.5~4 min
32MB	About 5~8 min
64MB	About 10~16 min

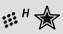
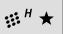
### Still Pictures Storage Capacity

Your pictures are stored as JPEG files. Pictures storage capacity depends on CF Card storage capacity and your built-in SDRAM memory.

Icon						
Resolution	1600x1200 pixels (2M pixels)		1280x1024 pixels (1.3M pixels)		640x480 pixels (VGA)	
Quality	High quality	Normal	High quality	Normal	High quality	Normal
Built-in SDRAM Memory	About 10 pictures	About 20 pictures	About 12 pictures	About 24 pictures	About 50 pictures	About 100 pictures
8MB CF Card Memory (Example)	About 16 pictures	About 32 pictures	About 20 pictures	About 40 pictures	About 80 pictures	About 160 pictures
<b>Note</b> This table is for your reference. Actual number of pictures stored may vary (up to $\pm$ 30%) depending on resolution and color saturation.						

(These tables are only for reference. )

## AVI Movies, Still Pictures and Voice Recording Storage Capacity

### Voice Recording

Your voice recording are stored as WAV files. Voice recording capacity depends on CF Card storage capacity and your built-in SDRAM Memory.

Built-in Memory	Estimated Voice Recording Time
Built-in SDRAM Memory	About 20 min.
CF Card Storage Capacity	Estimated Voice Recording Time
16MB	About 1 hour
32MB	About 2 hours
64MB	About 4 hours



(This table is only for reference. )



## Other Functions

### Self-timer

- Steps:

- (1) Rotate  (MENU control) to highlight  .
- (2) Press shutter button.
- (3) Counter will count down from ten and automatically release the shutter.

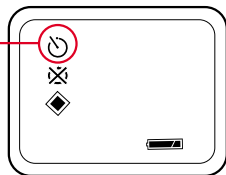





LCD Preview

### Erase All

All files(AVI, JPEG, or WAV) saved in built-in memory or CF Card will be deleted.

- Steps:

- (1) Rotate  (MENU control) to highlight  .
- (2) Press  and  starts blinking.
- (3) Press  again to confirm.

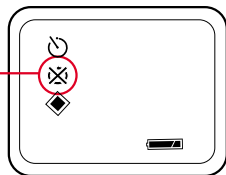

LCD Preview



## Other Functions



### Format CF Card

Select  on the LCD display to format the CF Card. (See P.9 for more on the Mode Selecting. )

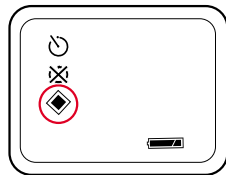

LCD Preview



- Gently insert CF Card to CF Card Slot. Do not force. Ensure CF Card is completely inserted.
- Do not eject CF Card while the camera is processing data.
- All recorded data will be completely lost if you format your card.
- We recommend CF Cards from Transcend, HP, PQI, PRETEC, Sandisk and Toshiba.

## Power

### Battery Indicators



Full



Low



Out of power



-  on the LCD display indicates low battery. Your taken pictures or AVI movies will be stored in the built-in SDRAM if a CF card is not inserted to the camera. Transfer data from built-in SDRAM Memory to your PC immediately to avoid data loss. All SDRAM data will be lost when the camera loses power from battery exhaustion or removal.
- When not using your camera for extended periods, we suggest you remove the batteries.

### LCD Backlight

To reduce power consumption, turn off the LCD backlight.



On



Off

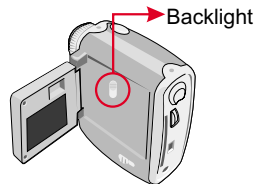

## For Best Results

- 1 Keep the focus set to  except for extreme close-ups.
- 2 Make sure your subject is well lit from the front.
- 3 Keep the camera level and steady when releasing the shutter.
- 4 Make sure you have adequate light when taking still pictures or movies.
- 5 For best quality video, move the camera slowly during filming.

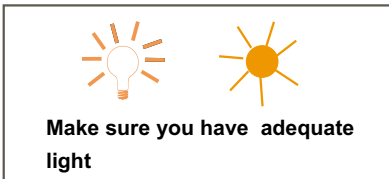
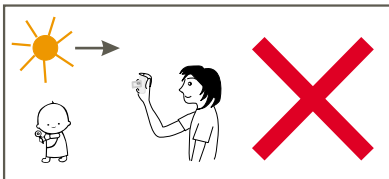
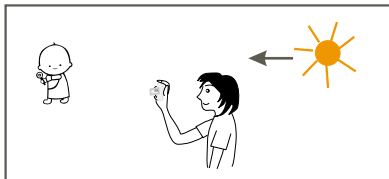



# A/V out Mode

## A/V out mode

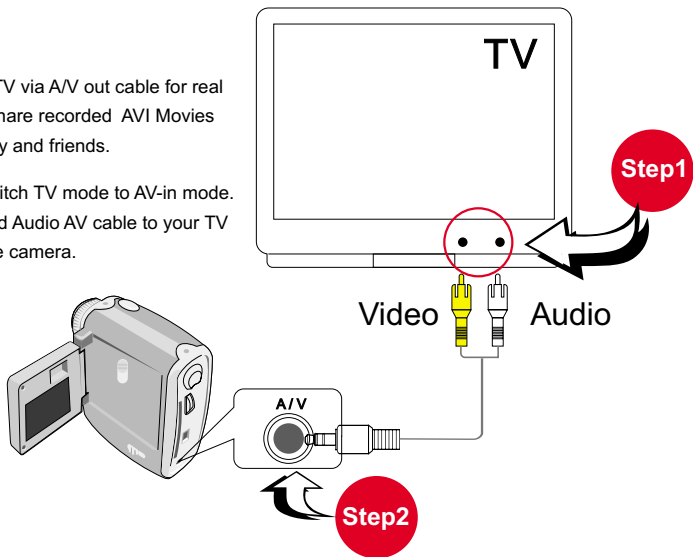

Connect your camera and TV via A/V out cable for real time display, and you can share recorded AVI Movies and pictures with your family and friends.

- (1) Turn on your TV and switch TV mode to AV-in mode.
- (2) Please plug in Video and Audio AV cable to your TV first and then plug in the camera.
- (3) Turn on the camera.



## TV Playback

### MENU

Press  and TV MENU will appear while camera successfully enters A/V out mode. Rotate  (MENU control) up or down to shift between modes. Press  to select mode.

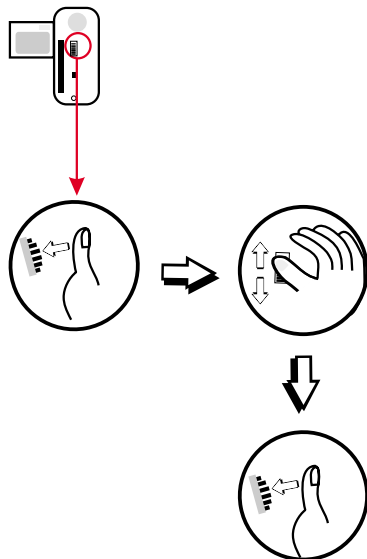
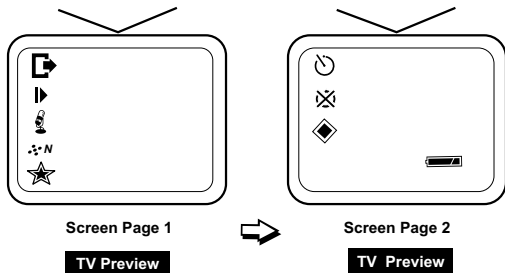

# Bundled Software



## Mega DV Manager and other bundled software packages

Mega DV Manager is your camera's driver as well as basic operating software. Your camera also comes bundled with the following video and image processing software. For more information, see each application's help file or visit the supplier's website.

### NetMeeting

[Http://www.microsoft.com/windows/netmeeting/default.asp](http://www.microsoft.com/windows/netmeeting/default.asp)

### VideoLive Mail

[Http://www.goCyberlink.com](http://www.goCyberlink.com)

### Power Director Pro

[Http://www.goCyberlink.com](http://www.goCyberlink.com)

### Media Show

[Http://www.goCyberlink.com](http://www.goCyberlink.com)

### Photo Explorer

[Http://www.ulead.com](http://www.ulead.com)

### Photo Express SE

[Http://www.ulead.com](http://www.ulead.com)

When using other applications to capture image, please see P30.

Applications	Main Feature
(1) Mega DV Manager	Mega DV Manager configuration software
(2) NetMeeting	Total Video Conference Software Solution
(3) VideoLive Mail	Create and Send Video E-mails
(4) Power Director Pro	Edit and Create Movies on CDs.
(5) Media Show	Make Animated Slide Shows for the Web or Screen Saver
(6) Photo Explorer	Manage Your Visual File
(7) Photo Express SE	Edit and Manage Your Photos and Albums



#### 1. Files in your camera are stored in:

H: DV Disk (DCIM folder)

(depends on your PC setting.)

#### 2. Files captured in Live mode are stored in:

C:/ Program Files /Mega DV Manager/  
Work Temp



# Software Installation

## Installing the Mega DV Manager

(1) Insert the CD-ROM in your CD drive. The installation menu should open automatically.

(2) Click  to start Mega DV Manager Installation.

(3) Follow the onscreen instructions to complete Installation.

(4) Click "Yes" to install Direct X 8.0. This will restart your PC.

(5)  icon will appear on PC desktop after Installation.

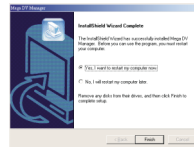
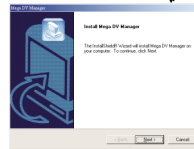

Click on " Finish" to complete installation.

# Hardware Installation

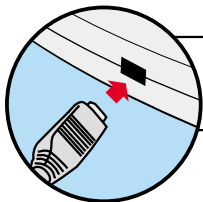

- 1 Connect the smaller end of the USB cable to the USB port of your camera.

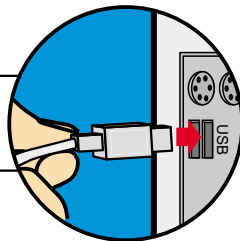

- 2 Plug the larger end of the USB cable to the USB port of your PC.





- Software installation must be completed before hardware installation.

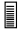

# Hardware Installation

## MS Windows XP/ME/2000 Users

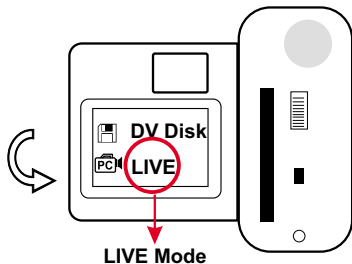

- (1) Installing "USB Mass Storage Device" Driver:  
Your PC will automatically install "USB Mass Storage Device" driver and complete "removable disk" installation. Your PC will add a "removable disk" under "My computer" icon.
- (2) Installing "Video Conference" Driver:  
Please rotate  (MENU control) to  and press  again to continue hardware installation.



# Hardware Installation



## MS Windows 98 SE Users:

- (1) Installing " USB Mass Storage Device " Driver:
  - 1-1 Please follow the onscreen instructions to complete " Removable disk " installation. Your PC will add a " removable disk " under " My computer" icon.
  
- (2) Installing " Video Conference " Driver
  - 2-1 During hardware installation, please rotate  (MENU control) to  and press  again to continue hardware installation.
  - 2-2 Please select " Automatic search for a better driver " when Fig 1 appears.
  - 2-3 MS Window 98SE users may be asked to insert licensed 98SE CD-ROM in your CD Drive. Please insert the CD-ROM.

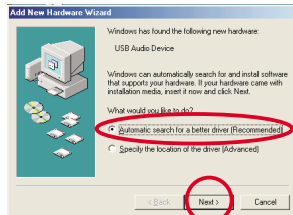

Fig 1





# Downloading Files from Camera to Your PC

## DV Disk Mode

Your camera can also serve as removable hard disk and allows you to download files from camera to your PC.

### ● Downloading Steps:

1. Rotate  (MENU control) to  and press  ( See Fig 1)
2. Click on " My Computer " or Windows Explorer. Then double-click "Removable Disk". Files are stored under the " DCIM" folder.
3. Double-click files and files will be automatically displayed by the default imaging software or AVI Movie player in your PC. And you can manually copy files to any folders you create.

※ Note: Your camera supports two kinds of memory storage: Built-in memory and CF Card. When a CF Card is inserted to your camera, only files in the CF Card can be downloaded to your PC. To download files on built-in memory to your PC, please eject the CF Card.

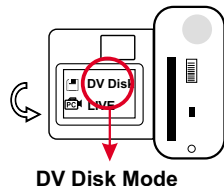
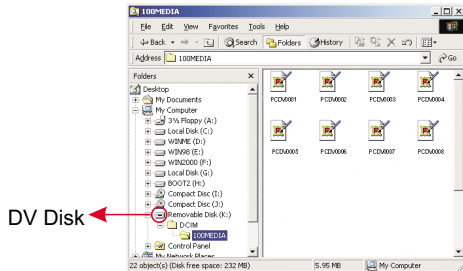

Fig 1







# Video Conference



When using video conferencing camera to capture image, please follow the instructions.

● Steps:

1. Rotate  (MENU control) to  and press  again. ( Fig 1 )
2. Launch Mega DV Manager .

Follow the following two ways to launch Mega DV Manager :

- 1 Click the "" icon on the Desktop to execute the program where you can begin to use your camera.

OR

- 2 Click on the "Start" menu and go up to "Programs". Then go to the folder named " Mega DV Manager" and select it.

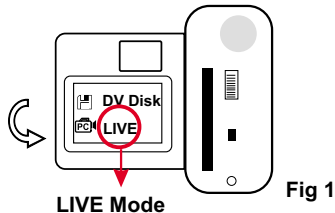

-  ● To uninstall Mega DV Manager, select " Uninstall Mega DV Manager"

OR

Reinstall Mega DV Manager to uninstall Mega DV Manager.

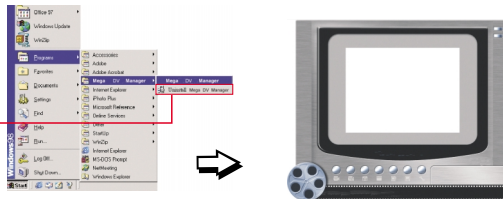

# Video Conference

Record a video clip

Stop recording

Snapshot

Set image size

Source

Preview or stop preview window

Settings

Preview Window

● **Files captured in Live mode are stored in:**  
C:/ Program Files /Mega DV Manager/  
Work Temp

# Video Conference



## Set Image Size

- **Color Space**

Select one of the following functions when you have different needs.

- RGB 24: better image quality
- I420: faster speed

- **Output Size**

Setting output size can change the size of the preview window. The default size is 320x240. Choose larger pixels when you need a larger preview window.

160 x 120
176 x 144
320 x 240
352 x 288
640 x 480

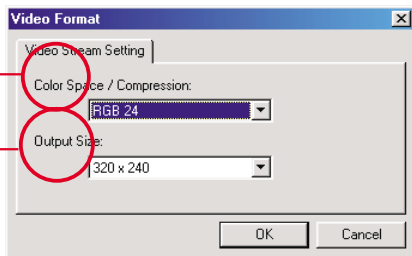

# Video Conference

## Set Source

- **Video Setting** ←

- Banding Filter:

When your PC screen flickers, please change the banding filter in Video Setting. The refresh rate (the number of times the screen is redrawn per second) is the most likely cause of flicker. Select 50Hz or 60Hz until your PC screen stops flickering.

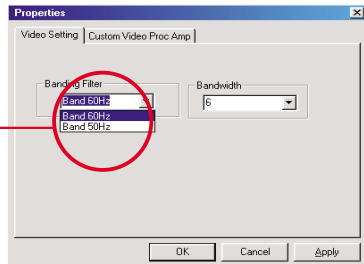

- **Custom Video Pro Amp** ←

You can use the default setting or change settings (brightness, contrast, saturation, sharpness, and hue) on your own.

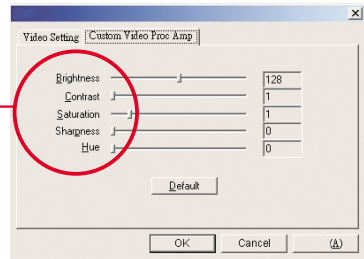

# Video Conference



## Set Settings

Your camera has default flicker settings. If pictures in DV Disk mode appear unnatural flickering noise, please select "Cancel Flicker" in the setting dialog.

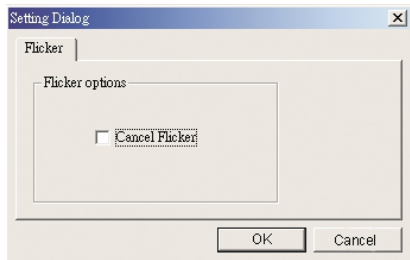

<b>Country</b>	England	Germany	France	Italy	Spain	Netherlands
<b>Setting</b>	50Hz	50Hz	60Hz	50Hz	50Hz	50Hz
<b>Country</b>	Portugal	America	Taiwan	China	Japan	Korea
<b>Setting</b>	50Hz	60Hz	60Hz	50Hz	50/ 60Hz	60Hz



# Troubleshooting

Symptom	Actions
Cannot turn on your camera.	<ul style="list-style-type: none"><li>● Press the MENU control for 3 seconds.</li><li>● Change new batteries.</li></ul>
Can't take pictures, record or voice record.	<ul style="list-style-type: none"><li>● Memory is full. Please transfer data to PC.</li></ul>
Data in internal built-in memory disappear.	<ul style="list-style-type: none"><li>● Transfer data to PC before the camera loses power from battery exhaustion.</li></ul>
TV doesn't show TV preview after AV-out cable is connected.	<ul style="list-style-type: none"><li>● Change AV-out port. Insert white cable to audio port and yellow one to video port.</li></ul>
Noise appears on PC screen while camera used as a video conferencing camera.	<ul style="list-style-type: none"><li>● Change Band Filter to 50 Hz or 60 Hz.</li></ul>
Images are blurred.	<ul style="list-style-type: none"><li>● Adjust the focus.</li></ul>
Images are too dark.	<ul style="list-style-type: none"><li>● Take pictures while there is adequate light.</li><li>● Use editing tools such as PhotoExpress to adjust image brightness.</li></ul>

# AIPTEK Service

If you have any problems, please contact AIPTEK office to which your country is assigned. Please note: If you reside outside of the United States or Germany, please contact AIPTEK Intl Inc.

## **AIPTEK, Inc.**

51 Discovery, Suite 100

Irvine, CA 92618, USA

TEL: 949-585-9600

FAX: 949-585-9345

<http://www.aiptek.com>

Online registration website:

[Http://www.aiptek.com/registration/registration.htm](http://www.aiptek.com/registration/registration.htm)

( Online registration entitles you to special services, downloads and promotions. )

## **AIPTEK International GmbH**

HalskestraBe 6

47877 Willich, Germany

TEL +49 21 54 - 92 35 50

Fax +49 21 54 - 92 35 68

<http://www.aiptek.de>

## **AIPTEK Int'l., Inc.**

No. 5-1 Innovation Road I

Science-Based Industrial Park

Hsin-Chu 300

Taiwan, R.O.C.

Tel: 886-3-5678138

Fax: 886-3-5678569

<http://www.aiptek.com.tw>



