

Basic Manual



W52P
by Panasonic

CDMA 1X

WIN

au by KDDI

Contents/
Getting Ready

Phone Call

Inputting
Characters

Address Book/
Pair Function

Mail

Camera

EZweb

EZ Navi

Simple Mode/
Teens Mode

Other Functions

Troubleshooting/
Remote Auto Lock

Index

Introduction

Thank you for purchasing the W52P.

Before using it for the first time, be sure to read the W52P Basic Manual (this PDF manual) so as to know how to use it correctly. After you finish reading this manual, store it and the printed materials that come with the phone in a safe place for future reference.

Printed Manuals for the W52P (Japanese)

The W52P comes with a Basic Manual and an Instruction Manual.

For information about basic operation



W52P Basic Manual
Equivalent to this English PDF manual.

For detailed information about each function



W52P Instruction Manual
English version not available.

The following information is also available on the au website.

- To download the Basic Manual/Instruction Manual
(<http://www.au.kddi.com/torisetu/index.html>)
- To access a keyword searchable au online manual
(<http://www.au.kddi.com/manual/index.html>)

You can also access the au online manual using EZweb.

EZweb Access

EZトップメニュー (EZ Top Menu)

→ auお客さまサポート (au Customer Support)

→ 調べる (Information)

→ オンラインマニュアル (Online Manual)

Info

The typeface, fonts, and colors of the texts on the screens provided for explanatory purposes in this manual may differ from the actual contents. Also, certain icons and the scroll bars may be omitted.

Cellphone Etiquette

Mind your manners!

A cellphone always emits weak radio waves while it is turned on. Enjoy operation of your cellphone without forgetting to be considerate of those around you.

Some locations do not allow the use of cellphones.

- Using a cellphone while driving is dangerous and prohibited by Traffic Control Law.
- Using a cellphone in an aircraft is prohibited by law. Be sure to turn off your cellphone.



Watch out where you use your cellphone, and keep your voice down.

- Do not make calls at cinemas, theaters, museums, libraries, or other similar locations. Turn the cellphone off or use Manner Mode to ensure that the ring tone does not disturb others.
- When in public, move to a location where you will not be blocking traffic.
- On the Shinkansen, in a hotel lobby, or in other similar locations, move to a location where you will not disturb others.
- Take care to avoid talking on the phone in a loud voice.
- Before taking the picture of others, be sure to obtain permissions first.



Cellphone radio waves may interfere with electrical medical equipment.

- On a train or in other crowded locations, there is always the possibility that someone nearby may be wearing a pacemaker. Turn your cellphone off when you are in a crowded area.
- Follow the rules of hospitals and other medical facilities prohibiting the use or possession of cellphones.



Cellphone Basics

Features

Camera

Shoot photos, record movies, and send them by e-mail.



▶ page 58

Mail

Send mail messages to other cellphones or to PCs.



▶ page 48

EZweb

Download “Chaku-Uta®”, wallpaper, and other data.



▶ page 64

Safety Buzzer

Use W52P as high-volume emergency buzzer by holding down  for about one second on standby.



▶ page 85

EZ Navi

EZ Navi Walk, Passenger Seat Navi, and Safety Navi allow you to get various kinds of location information. They are all built-in functions.



▶ page 70

In addition to the functions covered in this page, your W52P also has the **2** following features. → “Other Functions” (page 87)

Manner Mode and Easy Voice Memo

Manner Mode

Use Manner Mode to turn off the ring tone so as not to bother others around you.



While the standby screen is displayed, hold down  マナー for about one second.

▶ page 34

Easy Voice Memo

If you cannot answer a call, Easy Voice Memo plays an answering message and records the caller's message.



While the standby screen is displayed, hold down  for about one second.

▶ page 35

Checking Power, Signal Strength, and Battery Level

Normally leave the phone turned on.



The phone needs to be turned on to make and receive calls.

Hold down  for at least 1.5 seconds to turn on W52P. After a while, W52P turns on with tone and the standby screen appears.

▶ page 15

You cannot talk on the phone if it is unable to receive a signal.



Signal strength is low in some areas, even if they are within the service area.

 indicates the current signal strength.

▶ page 15

Keep an eye on the battery level.



The phone may not function properly if battery power is low.

 indicates the current battery level. ▶ page 15

Never use your cellphone while driving!

Holding a cellphone in your hand, talking on a cellphone, or looking at a cellphone display to send mail or to perform any other operation while driving is prohibited by Japanese law. (Revised Traffic Control Law, effective November 1, 2004)



× Reading mail or looking at the display.



× Holding a cellphone in your hand to talk.

Turn off your cellphone or use Drive Mode while driving.

Drive Mode

In Drive Mode, the phone will play the message “ただいま車を運転しています。・・・” (I am driving right now...), and ask the caller to leave a message using Easy Voice Memo.

While the standby screen is displayed, press

▶ マナー, and press あ (ON). Next, press か

(Drive Mode) to enter Drive Mode.



Beware of spam and one-ring calls!

How to Combat Spam

You can set up mail filters to block specific mail or mail identified as “未承諾広告※” (Unsolicited advertisement), which often includes spam.

Your cellphone has the following filters to block spam.

- blocks mail identified as “未承諾広告※” (Unsolicited advertisement)
- blocks specific mail
- blocks spoof e-mail



▶ page 55

Beware of one-ring calls!

A “one-ring call” (wan-giri in Japanese) rings your phone only once, in an attempt to make you call back to a service that automatically bills you very high charges.

The  icon at the head of an incoming record indicates that the call

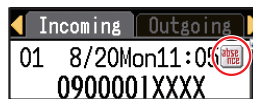

rang for only four seconds or less. This indicates a possible “one-ring call”.



▶ page 30

Disaster Message Board Service

Disaster Message Board

The Disaster Message Board lets you use EZweb to register information about your well-being in case of a major disaster. The information you register can be accessed from anywhere in Japan over EZweb or the Internet.

Registering the safety information

- ◆ When a major disaster strikes, you can use your au cellphone to access the “災害用伝言板” (Disaster Message Board) on EZweb and register your current condition, comments, and other information about your well-being.
- ◆ After you register information, it can be sent by mail to family, friends, and other individuals you have registered as a recipient of your Disaster Message Board information.

Checking the safety information

- ◆ Disaster Message Board information can be accessed by inputting the phone number of an individual over EZweb or the Internet.*
 - ※ Disaster Message Board information can be accessed from another type of cellphone, PHS, or PC at <http://dengon.ezweb.ne.jp/>.

How To Access

 ▶▶▶ Top Menu ▶▶▶ 災害用伝言板
(Disaster Message Board)

<http://dengon.ezweb.ne.jp/>



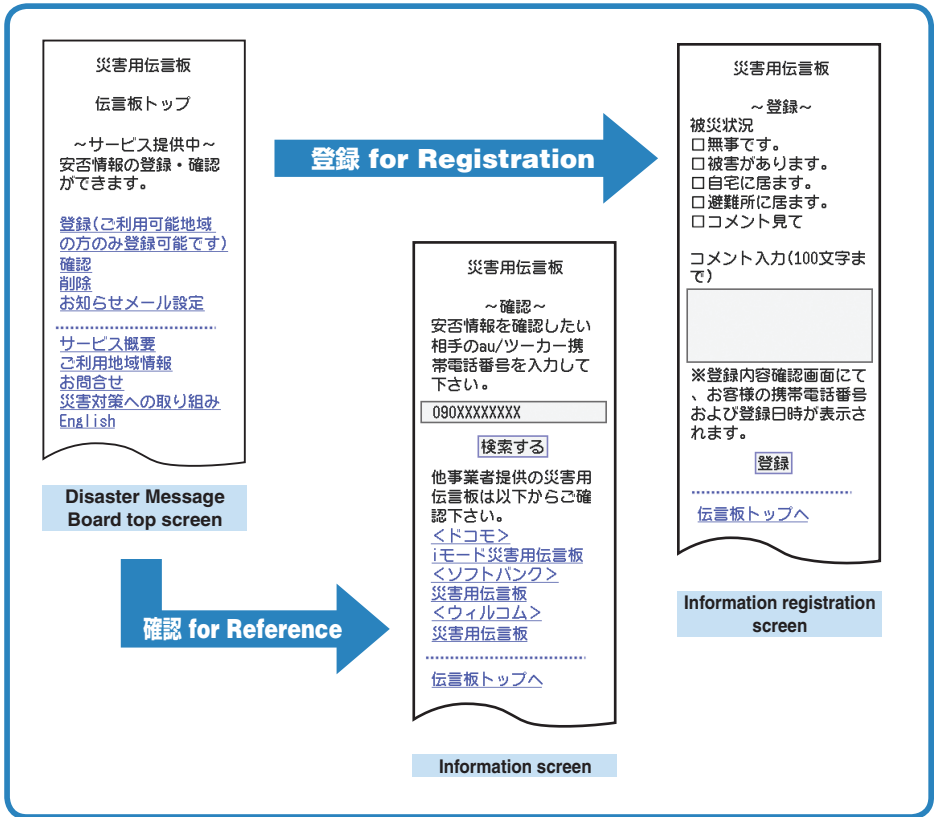

- ※ Registration contents are retained for up to 72 hours.
- ※ You can register up to 10 entries per phone number. Registering a new one while there are already 10, automatically overwrites the oldest.
- ※ You can view a Disaster Message Board demonstration at:
 → Top Menu → auお客さまサポート → 調べる → 災害用伝言板(デモ版)
 (au Customer Support) (Examine) (Disaster Message Board (Demo))
- ※ To view the Disaster Message Board in English, select the "English" option on the Disaster Message Board top screen.

Contents

Cellphone Etiquette 1

Mind your manners! 1

Cellphone Basics 2

Features 2
Manner Mode and Easy Voice Memo .. 3
Checking Power, Signal Strength,
and Battery Level 3
Never use your cellphone while driving! .. 4
Beware of spam and one-ring calls! 5
Disaster Message Board Service 6

Contents 8

Getting Ready 10

Checking the Contents of the Package.. 10
Names of Parts 11
Opening W52P by Using a Single Key
(One-push Open) 12
Charging the Battery 12
How to attach the +Panel™ 14
Turning Power On 15
Initial Values 15
Security Code and Passwords 16
Selecting English as the
Display Language 17
Basic Operations 19
Display Indicators 20
Main Menu 21
Initializing E-mail and EZweb 23
Checking Your Current Phone
Number and E-mail Address 24
Changing Your E-mail Address 25

Phone Call 27

Making a Call 27
Making an International Call 28
Answering a Call 29
Redialing (Outgoing Records/
Incoming Records) 30
One-ring Calls 30
Changing the Ring Tone 31
Adjusting the Ring Tone Volume 33
Adjusting the Earpiece Volume
during a Call 34
Turning On Manner Mode 34
Turning On Easy Voice Memo 35
Playing an Easy Voice Memo 36

Inputting Characters 37

Inputting an E-mail Address 38
Inputting Pictographs and
Useful Sentences 39

Address Book 41

Registering an Address Book 41
Editing an Address Book Record 43
Adding Outgoing or Incoming
Record Data to the Address Book .. 44
Dialing from the Address Book 45

Pair Function 46

Registering a Pair Partner 46
Making a Phone Call, Sending Mail to
Pair Partner 47

Mail	48	EZ Navi Features	70
Using E-mail.....	48	Simple Mode	72
Using C-mail	49	Entering Simple Mode	72
Creating and Sending E-mail Messages ..50		Exiting Simple Mode.....	73
Reading Received E-mail Messages..52		Using the Simple Mode Main Menu ...74	
Reading an E-mail Message with		Adding Data to the Address Book	
Attached Photos	53	in Simple Mode.....	75
Replying to a Received E-mail Message ..54		Using the Address Book	
Avoiding Spam.....	55	in Simple Mode.....	77
Creating and Sending C-mail Messages ..56		Creating and Sending E-mail	
Reading Received C-mail Messages..57		Messages in Simple Mode.....	78
		Shooting a Photo in Simple Mode.....	80
		Viewing Photos in Simple Mode.....	81
Camera Features	58	Teens Mode	83
Camera	60	Using Teens Mode	83
Shooting a Photo	60	Activating Teens Mode.....	84
Viewing Photos	62	Other Functions	85
Attaching a Photo to an E-mail		Safety Buzzer.....	85
Message.....	63	One-push Open	86
EZweb	64	Troubleshooting	89
Using EZweb	64	If you lose your W52P	90
Displaying the EZ Top Menu.....	65	Index	92
Bookmarking Sites			
You Frequently Access.....	66		
Viewing a Bookmarked Site.....	67		
Downloading Chaku-Uta-Full® and			
Chaku-Uta®	68		
Checking Charges	69		

Getting Ready

Before using the W52P, check the contents of the package comes with your W52P.

Be prepared to the basic operations such as; how to charge the battery, how to turn the power on, etc.



Checking the Contents of the Package

● W52P

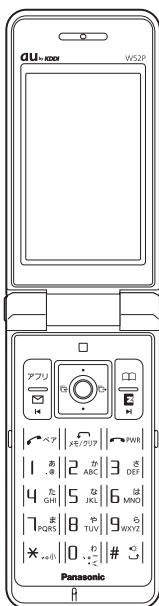

- +Panel™
(With 4 exclusive long screws,
Exclusive screwdriver,
Dust guard cushion)

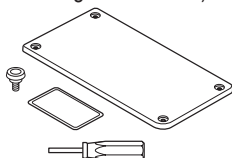

● Battery pack (51MAUAA)

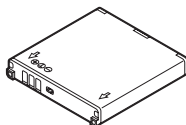

● Desktop holder (52MAPUA)

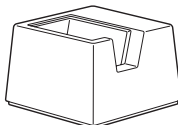

● CD-ROM



● Warranty (Japanese)

● OsaiFu Keitai® Basic Manual (Japanese)

● LISMO install guide (Japanese)

● Basic Manual (Japanese)



● Matsushita round-type earphone jack conversion adaptor 01 (01MAQNA)

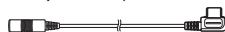

● MDR-E0931SP/BC (sample) by SONY

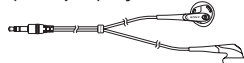

● USB cable (sample)

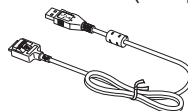

● Operating Precautions (Japanese)

● Global Expert Owner's Guide (Japanese)

● P NO KANZUME Contents Guidebook (Japanese)

● Promotional Fliers (Japanese)

● Instruction Manual (Japanese)



Info

- No microSD™ memory card is included.
- No AC adaptor is included. Please purchase a common AC adaptor 01 (option) if you have non.
- One +Panel is provided in the package, but a total of 7 panels are available as optional accessories.

Names of Parts

Front

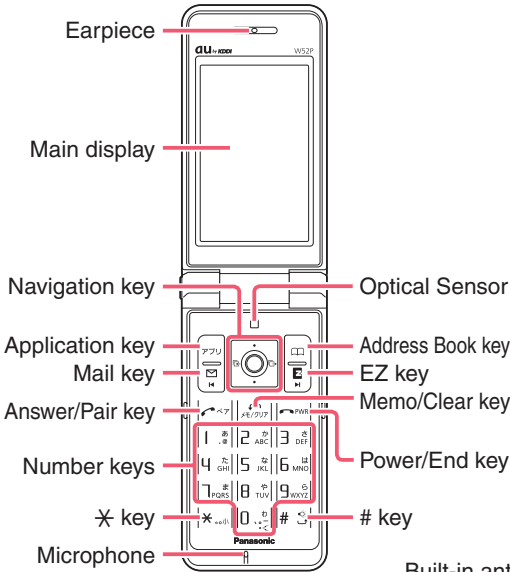

Back

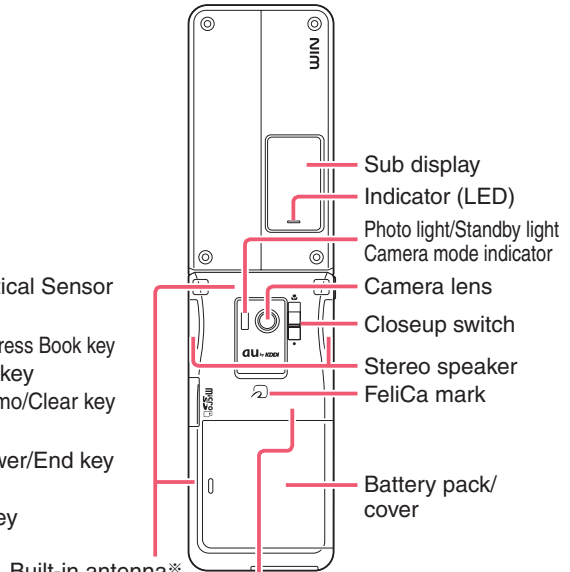

※ Do not cover the built-in antenna with your hand when using the phone, using EZweb, and when accessing GPS information.

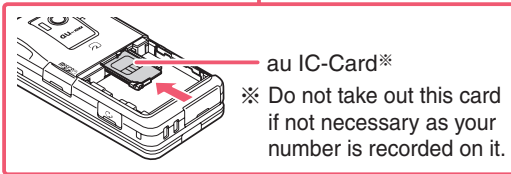

au IC-Card*
 ※ Do not take out this card if not necessary as your number is recorded on it.

Side

Flat-type earphone-microphone jack
 microSD memory card slot

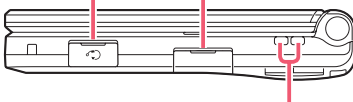

Strap eyelet

One-push open key

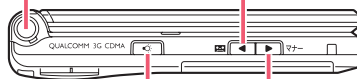

Up key (side)
 Easy Voice Memo key

Light key

Down key (side)
 Manner key

Infrared port



External connection jack

Charging terminals

Opening W52P by Using a Single Key (One-push Open)

You can open the W52P easily by pressing the key.
You can also open it manually without using the key.

1 Press the One-push open key.

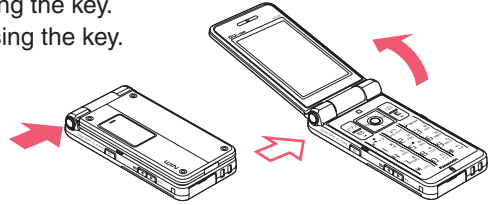



Info

- Your W52P might not open fully, depending on its direction.
- Be careful not to drop it by its rebound when opening your W52P by pressing the key.
- Be careful not to catch your fingers when opening your W52P.
- You need to close your W52P manually. If it does not close, once open it fully and close it.

Charging the Battery

The battery pack that comes with the phone is not fully charged when purchased. Be sure to charge the battery pack before using the W52P for the first time. Charging takes about 140 minutes.

You should recharge the battery pack whenever the battery level icon shows  or .

- Charging : Charge indicator (LED) is lit red.
- Charging completed : Charge indicator (LED) goes out.

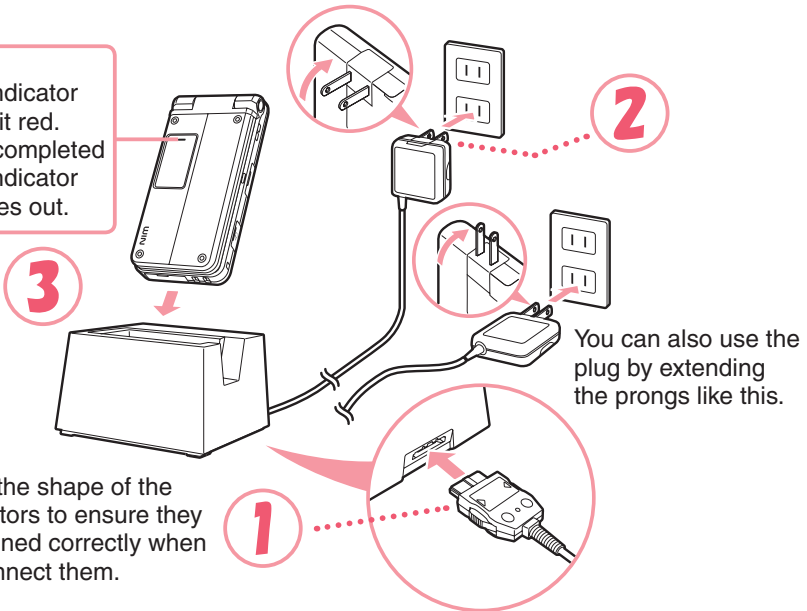

Caution!

- You must purchase a common AC adaptor 01 (option) for charging. Note that the configuration of the AC adaptor may be different from that shown in the illustration above.
- Pull out the connector of the common AC adaptor 01 (option) straight so as to be parallel to the W52P or the desktop holder connector terminal when you connect them.

1 Connect the common AC adaptor 01 (option) to the desktop holder.

Check the shape of the connectors to ensure they are aligned correctly before you connect.

Trying to force a connection may damage the connectors.

2 Fold out the power plug of the common AC adaptor 01 (option), and plug it into a 100V AC power outlet.**3 Insert the W52P into the desktop holder.**

This will cause the W52P LED indicator to light red, and  (charging battery icon) to display.

When charging is completed, the battery level icon will show  and the indicator will go out.

To remove the W52P from the desktop holder, holding the holder by hand and remove W52P.

※ You can connect the common AC adaptor 01 (option) to the W52P directly to charge the battery pack.

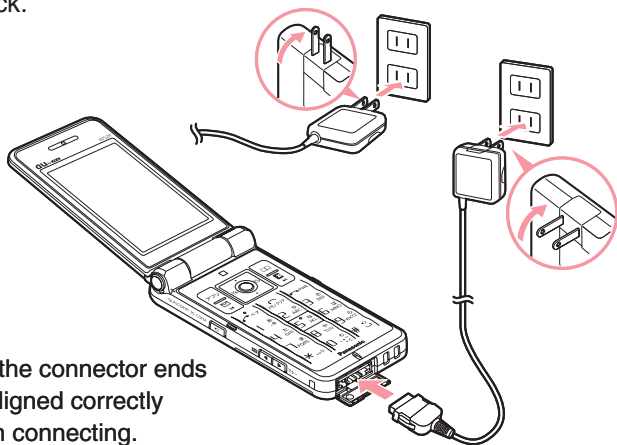

Check the shape of the connector ends to ensure they are aligned correctly (shown above) when connecting.

How to attach the +Panel™

You can attach the +Panel to the W52P if you choose to do so. You can also have fun with the +Panels by replacing one with another to suit the setting or mood you find yourself in.

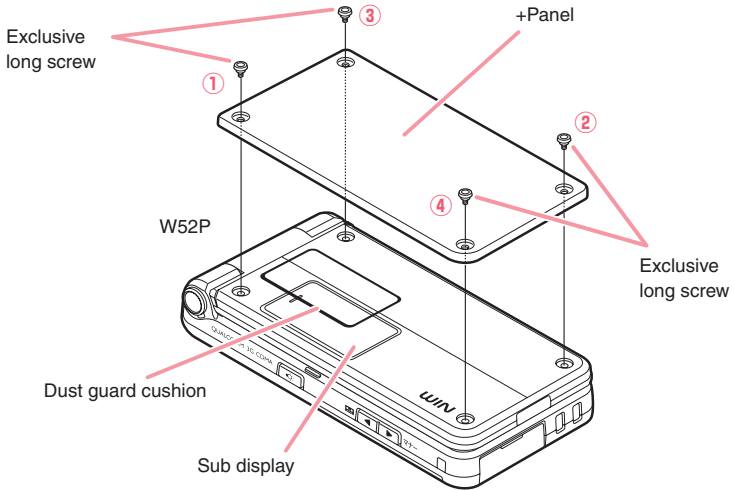
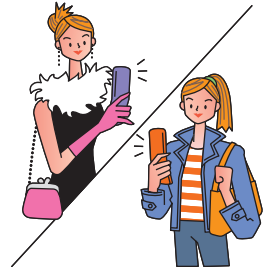

1 Remove the four short screws.

Do not lose or misplace the screws you have removed.

2 Use the four exclusive long screws to attach the +Panel.

Neatly align the +Panel with the sub display, and tighten the screws in ascending numerical order (① to ④).

Caution!

- ⊙ Use the exclusive screwdriver provided to attach or detach the +Panel.
- ⊙ Take care not to allow dirt or foreign matter to gain entrance between the +Panel and W52P.
You can effectively ensure that this will not happen by adhering the dust guard cushion in place around the circumference of the sub display before attaching the +Panel.
- ⊙ Keep the exclusive screwdriver in a safe place. You can use it to attach other +Panels, available as optional accessories.



Turning Power On

1 Hold down  for at least 1.5 seconds.





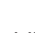

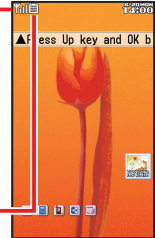

The standby screen appears.

Icon					
Signal Strength	Strong	Medium	Weak	Very Weak	Out of Range

- Communication is not possible while the signal strength icon is  (Out of Range).
- Communication may not be possible while the signal strength icon is  (Very Weak).



Standby screen

Icon						
Battery Level	Fully Charged	High	Medium	Low	Fully Discharged	During Charging

- The battery level icon  (Fully Charged) only shows during charging.

Turning Power Off

Hold down  for at least 1.5 seconds.

Initial Values

The initial values are as follows.

Lock No.	1234	Font Size	Add Book Char	Middle
Teens Lock No.	1234		Input	Middle
Caller ID	ON		Mail Char	Middle
Incoming Display	ON		EZweb Char	Small
Profile	Blank		Data Folder Char	Middle
			Text Memo Char	Middle

Security Code and Passwords

The W52P lets you use the numbers and passwords described below. Do not forget your numbers and passwords. You will need them to perform various operations and to access subscription services.

Security Code

Usage Examples	① For remote operation of the Voice Mail and Call Transfer from a standard phone
	② For inquiries, applications, and service modifications using au Customer Service Center voice guidance, au website, and EZweb
	③ For changing e-mail settings
Initial Values	The 4-digit number you entered on your subscription contract

Lock No.

Usage Examples	For modifying various phone settings
Initial Values	1234

Teens Lock No.

Usage Examples	For modifying various phone settings in Teens Mode
Initial Values	1234

EZ Password

Usage Examples	For entering and canceling subscriptions for EZweb fee-based content
Initial Values	The 4-digit number you entered on your subscription contract



Premium EZ Password

Usage Examples	① For entering and canceling subscriptions for EZweb fee-based content paid for using “まとめてau支払い” (au Collective Payment Service)
	② For purchasing products from EZweb sites that use “まとめてau支払い” (au Collective Payment Service)
Initial Values	The 4-digit number you entered on your subscription contract

Selecting English as the Display Language

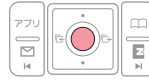
1 While the standby screen is displayed, press .



2 Use  to select “機能設定” (settings), and press .

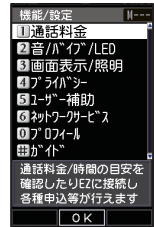
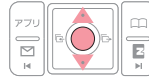

3 Press  (画面表示/照明) (ScreenSetup/DisplayLighting).

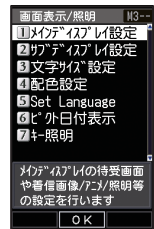

▶ Continued on the next page

4

5 (Set Language).

ベア	メモ/クリア	PWR
1 あ	2 か	3 さ
4 た	5 な	6 は
7 ま	8 や	9 ら
* 0	#	



5

2 (English).

This selects English as the display language.

ベア	メモ/クリア	PWR
1 あ	2 か	3 さ
4 た	5 な	6 は
7 ま	8 や	9 ら
* 0	#	

Caution!

Even if English is selected as the display language, schedule and other dates are displayed in the format year/month/day. Folder names inside of the Data Folder are also displayed in year/month/day format.

Basic Operations

Key functions

- Displays incoming records.
- Returns to the previous menu screen.
- Selects an item.

- Displays the standby shortcut icon.
- Selects an item.

- Displays the EZ apps menu.

- E-mail
- C-mail (hold down for about one second)

- Dials/answers a phone call.
- Displays the Pair function.

- Memo
- Toggles Easy Voice Memo on and off (hold down for about one second).
- Deletes a character.
- Returns to the previous menu screen.

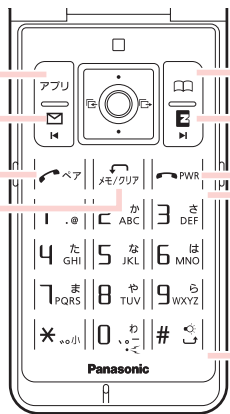
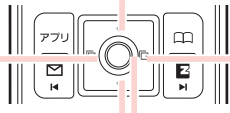

- Selects EZ news flash telop/window.
- Selects an item.

- Displays outgoing records.
- Scrolls forward one menu screen.
- Selects an item.

- Displays the main menu.
- Applies an item.

- Displays the address book.
- Creates a new address book (hold down for about one second).

- Displays the EZ menu.

- Toggles power on and off (hold down for about 1.5 seconds).
- Hangs up.
- Terminates a function.
- Returns to the standby screen.

- Inputs phone number.
- Inputs text character.

Side key functions

- Easy Voice Memo (Receiving a call)
- Recording the caller (during a call)
- Page scroll at browser display.

- マナー
- Toggles Manner Mode on and off (hold down for about one second).
- Page scroll at browser display.

- Lighting of standby light (hold down for about one second)

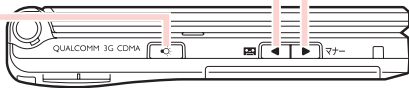

Info

- If you lose track of where you are or if you make a mistake, press to scroll back to the previous, press to return to the standby screen.
- When is in the lower right corner of the photo or movie screen, pressing will display key help.
- Holding down for about one second toggles side key's disabling feature on and off while W52P is folded. To cancel the side key's disabling feature, follow the procedure above with W52P opened.

Display Indicators

The following explains the main icons that appear on the standby screen.

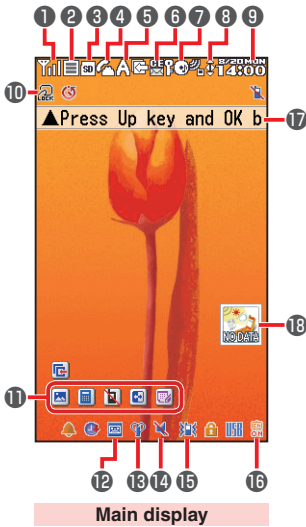

Main display

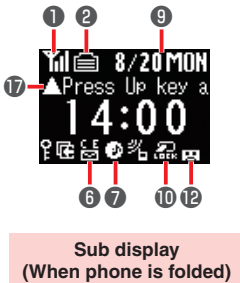

Sub display

(When phone is folded)

1		Signal strength
2		Battery level
3		A microSD™ memory card (commercial item) is inserted into the cellphone.
4		During a call
5		EZ apps (BREW®)/Hello Messenger/PC site viewer on
6		Unread mail
7		au Music Player/SD-Audio Player/EZ•FM on
8		Key guidance on the EZweb screen (while browsing) or the EZ Channel-Plus program screen (while playback), etc.
9		Current time The date and time are set automatically.
10		FeliCa Lock on
11		Selects the user defined icons such as photo, calculator, Emission Off Mode, Mode Settings, Note Pad 01 by pressing and
12		Easy Voice Memo on
13		Manner Mode on
14		Ring tone off
15		Vibrator on
16		EZ Channel-Plus is in use.
17	-	EZ news flash telop
18	-	EZ news flash window

Key symbols used in this manual

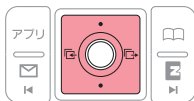

The navigation key in this manual is described with the key symbols shown below.





or key:

or key:

, , or key:

Main Menu

Pressing  while the standby screen is displayed displays the main menu. Use  to select the item, and press  (OK) to access the function associated with the item.

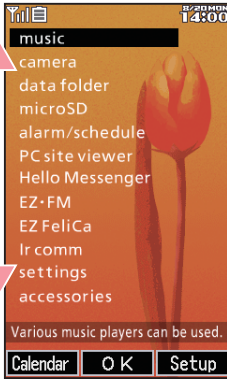

music

Various music players can be used

camera

Photo/movie/barcode reader can be used

data folder

Displays data in W52P

microSD

Displays data in the microSD™ memory card

alarm/schedule

Alarm/Schedule function can be used

PC site viewer

The Web site for PC can be seen

Hello Messenger

Communicates with characters/voice/photo

EZ-FM

FM radio can be listened

EZ FeliCa

EZ FeliCa can be used/set

Ir comm

Various data can be received/sent via Ir

settings

Various settings can be customized

accessories

Various useful functions can be used

Info

Main menu is different from those in the illustrations above according to the body color of your handset.



Using the Main Menu

Example: To display the setting screen from the main menu.

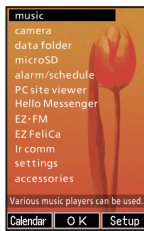

 returns to the previous screen.



Press  to select "settings", and press  (OK).

 returns to the previous screen.

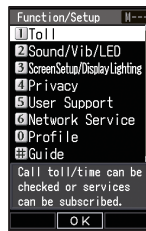

 returns to the standby screen.

Using Soft Keys

Soft keys are the keys you use to execute the functions along with the bottom of the screen. The table below explains how to assign the soft keys to the on-screen functions. Note that the function of each soft key depends on the currently displayed screen.

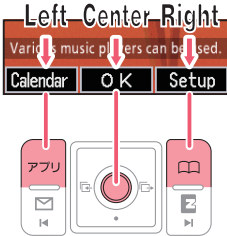

Left soft key		Executes the function on the left.
Center soft key		Executes the function on the center.
Right soft key		Executes the function on the right.

Using Menus

Pressing the soft key that corresponds to the “Menu” at the bottom of the display will display a menu of various operations related to the function you are currently using.

Example: To open the photo monitor menu screen from photo monitor screen.

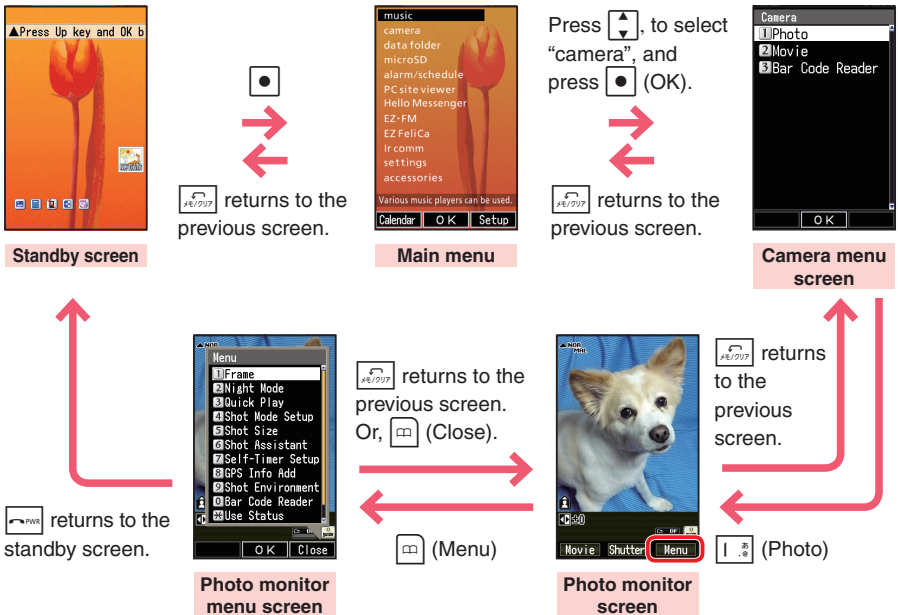



Initializing E-mail and EZweb

An EZweb subscription is required to use e-mail and EZweb. If you did not subscribe when you purchased your phone, contact your nearest au shop or the au Customer Service Center.

※ You will be assigned an e-mail address automatically when you perform the EZweb initialization procedure.

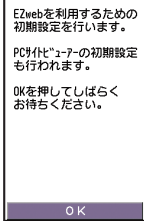
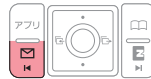
1 While the standby screen is displayed, press .



2 Press  (OK).

Wait until the phone connects to the server for initialization.

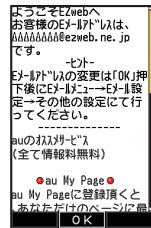
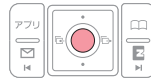

3 After your automatically assigned e-mail address appears, press  (OK).

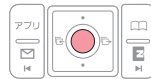

Info

Pressing  /  also allows you to make initial settings.



Checking Your Current Phone Number and E-mail Address

My phone number and mail address

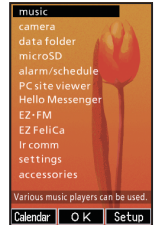
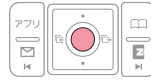

1 While the standby screen is displayed, press .



2 Use  to select “settings”, and press  (OK).

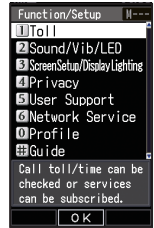
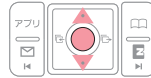



3 Press  (Profile).

Your current phone number and e-mail address appear.



Info

Your phone number and e-mail address can be checked by pressing , and  while the standby screen is displayed.

Changing Your E-mail Address

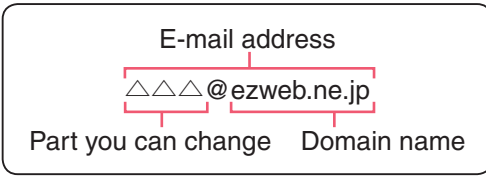

1 While the standby screen is displayed, press .

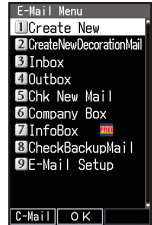
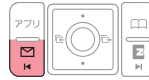

2 Press (E-Mail Setup).

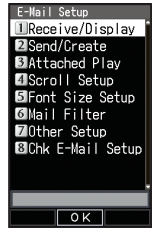

3 Press (Other Setup).

When the EZweb connection confirmation screen appears, press (Yes).

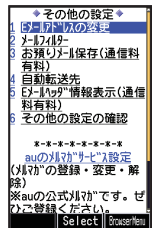

4 Press (Eメールアドレスの変更) (Change E-mail Address).

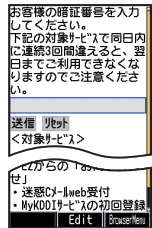

▶ Continued on the next page

5 Enter your Security Code, press (OK), use to select “送信” (Send), and press (Select). Use to select “承諾する” (Accept), and press (Select).



E-メールを変更します。
ご希望のE-メールを入力してください。

※入力時の注意※
1. 半角英数小文字で「@ezweb.ne.jp」より左側のみを入力ください。
2. E-メールは半角英数字30文字まで入力可能です。
記号は「.」、「-」、「_」が使用可能です。「!」、「」は最初には利用できません。最初には数字の「0」を使用することはできません。

Back Browse/Menu

6 Use to select the text box, and press (Edit). Enter the e-mail address you want, and press (OK).



2. E-メールは半角英数字30文字まで入力可能です。
記号は「.」、「-」、「_」が使用可能です。「!」、「」は最初には利用できません。最初には数字の「0」を使用することはできません。

AAAAAAAAAAAA@ezweb.ne.jp

送信 実行

前のページへ

Select Browse/Menu

To input an e-mail address
→ “Inputting an E-mail Address” (page 38)

7 Use to select “送信” (Send), and press (Select).

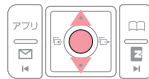

新しいE-メールは
AAAAAAAAAAAA@ezweb.ne.jp
です。
よろしいですか？

OK 実行

Select Browse/Menu

The e-mail address confirmation screen appears.

8 Press to select “OK”, and press (Select).

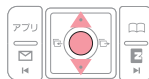

The message “正常に変更されました。” (Update is complete.) appears to indicate that your e-mail address has been changed.

Info

- ◎ Your Security Code is the 4-digit number you entered on your subscription contract. If the wrong Security Code is entered three times a day, the setting operation will be disabled until the following day.
- ◎ If your e-mail address won't change in step 7:
The new e-mail address you entered may be registered by someone else already. Try entering a different address.

Phone Call

Making a Call

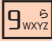
- 1 While the standby screen is displayed, use the number keys (0  to 9 ) of the keypad to enter the phone number you want to call.



When calling a standard phone, you need to enter the area code.

- 2 Press .

After you finish a call, press  to hang up.

※ The caller always hears your voice even when you cover the microphone with your hands.



Send Methods

※ Displayed when you press  (Call) in step 2.

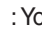
Call  : Your phone number is provided to the party you are calling in accordance with the caller ID setting of your phone.

184 Add : Your phone number is not provided to the party you are calling.

186 Add : Your phone number is provided to the party you are calling.

Making an International Call

■ au International Call Service

Available without any additional application

Ex: To call 212-123-△△△△ in the USA

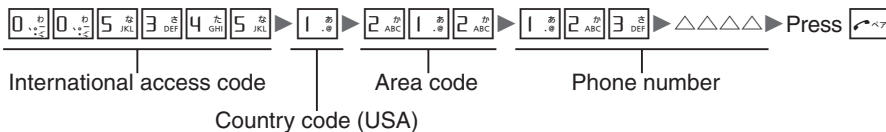

- Calling charges for this service are added to monthly mobile phone calling charges and billed together.
- Please check the Country code at the au Customer Service Center.
- For charges, please refer to the au MOBILE PHONE SERVICE GUIDE or contact the au Customer Service Center.

■ 001 KOKUSAI MOBILE TALK

Application required.

For inquiries, please contact the KDDI Customer Service Center.

 **0077-7160** (toll-free; open 9:00 to 20:00 everyday including weekends and national holidays)

Ex: To call 212-123-△△△△ in the USA

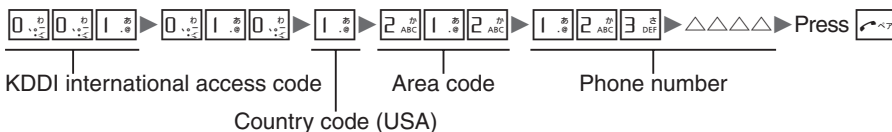

- Charges for 001 KOKUSAI MOBILE TALK are charged separately from monthly au telephone charges.
- Please check the Country code at the au Customer Service Center.
- For charges, please refer to the au MOBILE PHONE SERVICE GUIDE or contact the au Customer Service Center.

Answering a Call

1

Press  to answer an incoming call.

After you finish a call, press  to hang up.



Info

Open to Talk function

You can also answer the call just by opening W52P.

→ “To set Open to Talk” (Page 86)

Display for Incoming Calls



If the caller's name is in your address book, it appears on the display. If not, only the caller's phone number is displayed.

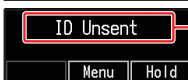

A message appears when the phone number of the caller is not provided for some reason.



ID Unsent : The caller's phone refused to send its phone number.

Pay Phone : The call is from a pay phone.

Not Support : The call is from a phone that does not support caller ID.

Missed Call Notification



The message “ Call X” appears on the display if you did not answer one or more calls. Press  (OK) to check incoming records (caller phone number, etc.).

To redial a number



→ “Redialing (Outgoing Records/Incoming Records)” (page 30)



Redialing (Outgoing Records/ Incoming Records)

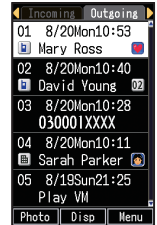
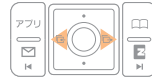

1 While the standby screen is displayed, press .



- : Displays outgoing records.
- : Displays incoming records.

2 Use  to select the record whose number you want to dial, and press .

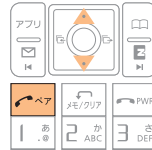

Info

The phone stores up to 50 records each for the outgoing records and incoming records. When a record is created while there are already 50 in memory, the oldest is deleted automatically to make room for the new one.



One-ring Calls

What is a “one-ring call”?

A “one-ring call” is an incoming call that rings your phone only once, which aims it to be stored in your incoming records. If you redial the number shown in your incoming records, often you are connected to a dating service or some other service that may bill you very high charges. Always keep in mind that it is not a good idea to call back unfamiliar numbers.

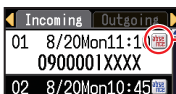
One-ring call indicator





The  icon indicates an incoming call you did not answer. The  icon indicates an incoming call that rang for four seconds or less, which may be one-ring call with high possibility.

Changing the Ring Tone

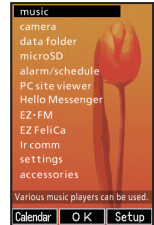
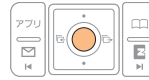

1 While the standby screen is displayed, press .



2 Use  to select “settings”, and press .

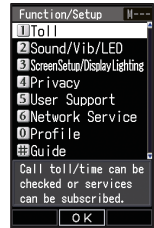
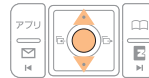

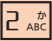
3 Press  (Sound/Vib/LED).

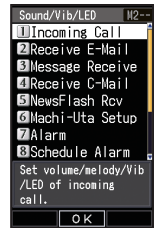

4 Press  (Incoming Call).

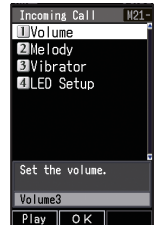

▶ Continued on the next page

5 Press (Melody).



6 Press (Fixed Sound).

To hear the currently selected ring tone, press  (Check).

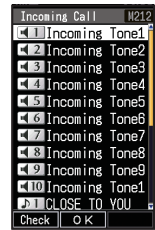

7 Use to select the ring tone you want, and press .

The ring tone is set.

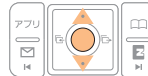

Info

- ◎ The initial setting is “Incoming Tone1”.
- ◎ You can also download a “Chaku-Uta®” from the Internet and use it for your ring tone.
→ “Downloading Chaku-Uta-Full® and Chaku-Uta®” (page 68)

Adjusting the Ring Tone Volume



To adjust the ring tone volume, perform steps 1 through 3 under “Changing the Ring Tone” (page 31), and continue with the following steps.

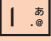

1 Press  (Incoming Call).



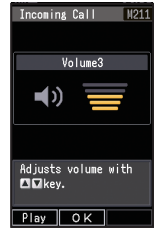

2 Press  (Volume).

To hear the ring tone at the current volume setting, press  (Play).

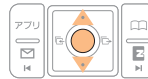

3 Use  to adjust the ring tone volume, and press .



: Increases volume.

: Decreases volume.

Info

Step-up : Ring tone volume gradually increases.

Step-down : Ring tone volume gradually decreases.

Mute : Ring tone does not sound.

To display the “Step-up” and “Step-down” settings, select volume level 5, and press .

To display the “Mute” setting, select volume level 1, and press .

Adjusting the Earpiece Volume during a Call



1 During a call, use  to adjust the volume.

: Increases volume.

: Decreases volume.

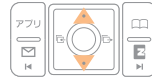

You can adjust the earpiece volume (level 1-6).

When you set the maximum volume (level 6),  is displayed on the screen.

Turning On Manner Mode

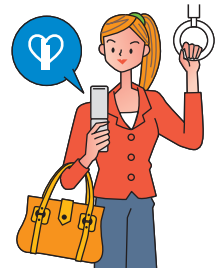

While Manner Mode is on, the phone alerts you to incoming calls by vibrating.

1 While the standby screen is displayed, hold down  マナー for about one second.

When Manner Mode is on, the  icon appears on the display.



Turning on Manner Mode also turns on Easy Voice Memo, which is indicated by  on the display.

While Manner Mode is on, the phone vibrates without sounding its ring tone.

To turn off Manner Mode, hold down  マナー for about one second.

Turning On Easy Voice Memo



1

While the standby screen is displayed, hold down  for about one second.

When Easy Voice Memo is on, the  icon appears on the display.



Phone Call

W52P can store up to 4 Easy Voice Memos, each of which can contain up to 20 seconds recording time.

If a new Easy Voice Memo is recorded when there are already four in the memory, the oldest, unprotected, and has already been played back is deleted automatically to make room for the new one. Protected Easy Voice Memos are not deleted.

To turn off Easy Voice Memo, hold down  for about one second.

Info

Using the Voice Mail

The Voice Mail allows callers, who could not reach you to leave voice messages, when the phone is turned off, or when you are not in a location within the range of the service with adequate signal strength.

Playing an Easy Voice Memo



When Easy Voice Memos are stored.

The messages “ Call” and “ EasyVoiceMemo” appear on the standby screen.



1 Select “ Call”, and press (OK).

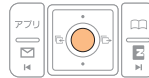

The incoming records list appears.

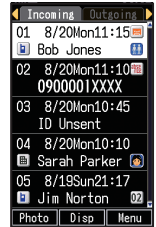

2 Use to select the record with the icon, and press (Disp).

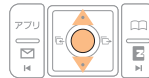

The incoming record detail screen appears.

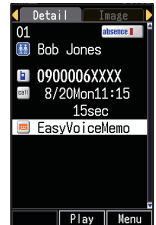

3 Use to select “ EasyVoiceMemo”, and press (Play).

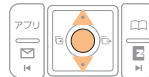

The easy voice memo plays back.







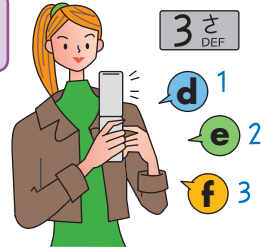

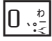
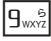

Info

To delete an Easy Voice Memo, press while the standby screen is displayed. Select the Easy Voice Memo you want to delete, press (Menu), and (Delete). Next press (Delete One), and press (Yes).

Inputting Characters

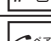
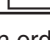

Input characters using keypad keys  through . The table below shows the characters each key cycles through when you press it.

Key	Number of Presses								
	1	2	3	4	5	6	7	8	9
 あ .@	.	@	-	_	/	:	~	1	
 か ABC	a	b	c	A	B	C	2		
 さ DEF	d	e	f	D	E	F	3		
 た GHI	g	h	i	G	H	I	4		
 な JKL	j	k	l	J	K	L	5		
 は MNO	m	n	o	M	N	O	6		
 ま PQRS	p	q	r	s	P	Q	R	S	7
 や TUV	t	u	v	T	U	V	8		
 ら WXYZ	w	x	y	z	W	X	Y	Z	9
 ゜ 0 .@ - _ / : ! ? ~ () * # + , ^ ; < = > \$ ¥ % & [] ' ` { } ~	0 . @ - _ / : ! ? ~ () * # + , ^ ; < = > \$ ¥ % & [] ' ` { } ~								
 * 小	Toggles between upper case and lower case (Example: a ⇔ A).								
 # 前	Returns to the previous character.								
 へア	Undoes the last delete operation.								

- In order to input consecutive characters that are assigned to the same key, press  to move the cursor (highlighted), then press the same key to input next character.

Caution!

Allowable Characters in Your E-mail Address

Your e-mail address (the part at the left of “@”) can contain up to 30 characters, including single-byte English lower case letters, hyphens (-), periods (.) and underbars (_).

A period (.) or a zero (0) cannot be used as the first character.

Characters and symbols that are shaded in the table above cannot be used at the left of “@” in the address format “△△△@ezweb.ne.jp”.

Info

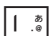
You can input a period (.) or “at” symbol (@) by pressing .

Inputting an E-mail Address

Inputting “david@ezweb.ne.jp”

In this example, we will input “david@ezweb.ne.jp” for “<E-Mail Add1>”. To input “<E-Mail Add1>”, perform steps 1 through 6 under “Registering an Address Book” (page 41), and perform the following steps.



1 Input “david”.

- To input “d”: Press once.
- To input “a”: Press once.
- To input “v”: Press three times.
- To input “i”: Press three times.
- To input “d”: Press once.

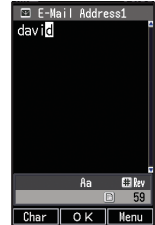

2 Press (Menu).

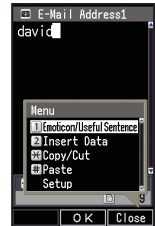

3 Press (Emoticon/ Useful Sentence), and (Useful Sentence).



4 Use to select “@ezweb.ne.jp”, and press (OK).

“david@ezweb.ne.jp” is inputted.
You could also input “@ezweb.ne.jp” by pressing .

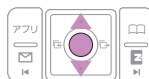

Inputting Pictographs and Useful Sentences

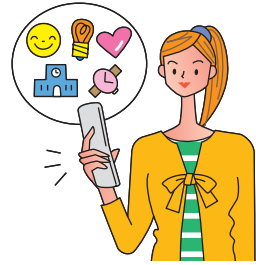

The following procedure shows how to input pictographs and useful sentences into the body text when creating a new e-mail message.

1 Press (Char), and (Pictograph).

You can also select a pictograph by pressing .

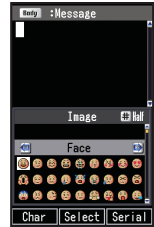

2 Use to select the pictograph you want, and press (Select).

Use and to scroll through the various categories of pictographs. To input consecutive pictographs, press (Serial).

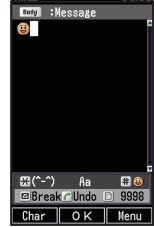
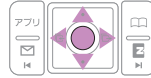

3 Press (Menu), (Emoticon/Useful Sentence), and (Useful Sentence).



4 Use to select the useful sentence you want, and press (OK).

Here we will select “Happy birthday!”. You can also input “Happy birthday!” by pressing .

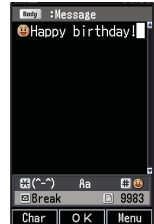
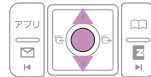



Info

The following shows the input screens for symbols (double-byte) and emoticons.



Inputting Symbols (Double-byte)



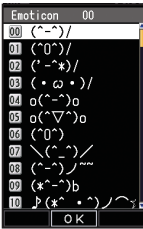

In step 1 of the procedure above, press  (Char), and  (&@) to display the “FullSym” (double-byte symbol menu).

Inputting Emoticons



In step 3 of the procedure above, press  (Emoticon) in place of  (Useful Sentence) to display the emoticon menu.

You can also display the emoticon menu by pressing  (*_*) in place of  (Menu) in step 3.



Address Book

Registering an Address Book





- 1** While the standby screen is displayed, hold down  for about one second.



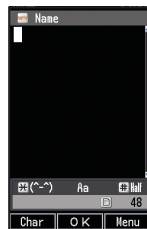



- 2** Select “ <Name>”, and press  (Edit).

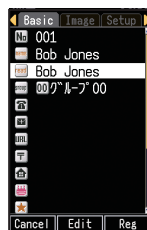

- 3** Enter the name, and press  (OK).

The  (Reading) is generated automatically when you enter a name. To input text → “Inputting Characters” (page 37)



- 4** Use  to select “ <Phone Number1>”, and press  (Edit).

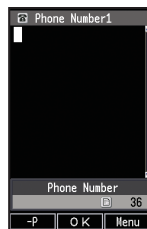

▶ Continued on the next page

5 Enter the phone number, and press (OK).

When entering the number of a standard phone, be sure to include the area code.

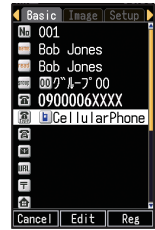

6 Use to select “ <E-Mail Add1>”, and press (Edit).

If you do not want to enter an e-mail address, jump to step 8.

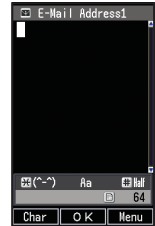
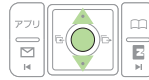

7 Enter the e-mail address, and press (OK).



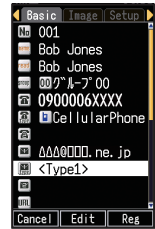

To input an e-mail address
→ “Inputting an E-mail Address”
(page 38)



8 Press (Reg).

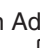

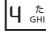

Info

- The Address Book can contain up to 700 records.
- Address Book Records are numbered from 000 through 699. A new record is automatically assigned to the lowest available unused record number.
- An Address Book Record can also contain a website URL, street address, birthday, and other personal information.
- To delete an Address Book Record press  while the standby screen is displayed. Use  to select the Address Book you want to delete. Press  (Menu), and  (Delete). Next press  (Delete One), and press  (YES).



Editing an Address Book Record



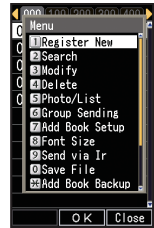

Example: To edit the phone number of “Bob Jones”



1 While the standby screen is displayed, press , use  to select the record you want to edit, and press  (Menu).

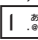



2 Press  (Modify), and  (Overwrite).

To delete an address book record, press  (Delete), and press  (Delete One). Next, press  (Yes).

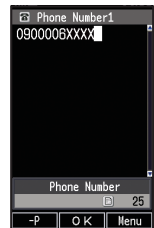

3 Use  to select “ 0900006XXXX”, and press  (Edit).



4 Make the changes you want, press  (OK), and  (Reg).

To delete characters, press .



Adding Outgoing or Incoming Record Data to the Address Book



1 While the standby screen is displayed, press , use to select the phone number you want to save, and press (Menu).

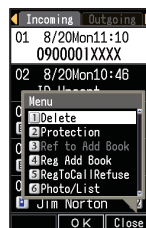

: Displays outgoing records.

: Displays incoming records.

2 Press (た GHI) (Reg Add Book).





3 Press (あ) (Reg New).

To enter the name, use the procedure starting from step 2 under “Registering an Address Book” (page 41).



Dialing from the Address Book



- 1** While the standby screen is displayed, press , and use  to select the record whose phone number you want to dial.



- 2** Press  (Disp).

The details screen of the record appears.

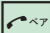

- 3** Use  to select the phone number, and press .



Pair Function



You can save up to five phone numbers (like frequently used ones from the address book).
You can make calls, send mails with these saved numbers (called Pair Partners) more easily.

Registering a Pair Partner

1 While the standby screen is displayed, press .

If the Pair partner is not registered, the confirmation screen appears. Press (OK). Use to select the 1 through 5 tab where you want to register the Pair partner.



2 Use to select "Register • Check", and press (OK).

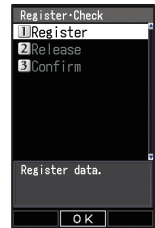
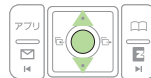

3 Press (Register).



4 Use to select the address book record for the person you want to register as a Pair partner, and press (Select).

When there is more than one phone number/e-mail address registered in the address book, the Pair function phone number/e-mail address selection screen will appear.

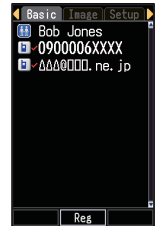

5 Press (Reg).

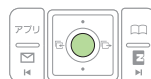

Making a Phone Call, Sending Mail to Pair Partner



1 While the standby screen is displayed, press .

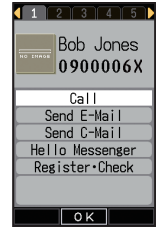

2 Use to select the Pair partner.

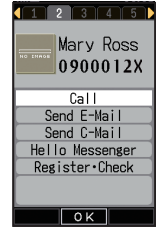
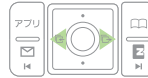

3 Use to select "Call", and press (OK).

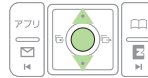

Sending e-mail : After selecting "Send E-Mail" and pressing (OK), selecting "Create New" and pressing (OK) will display a screen for a composing and sending an e-mail message.

Sending C-mail : Selecting "Send C-Mail" and pressing (OK), will display a screen for a composing and sending a C-mail message.

For the subsequent procedure, refer to "Creating and Sending E-mail Messages" (page 50) / "Creating and Sending C-mail Messages" (page 56).

Info

- In order to register a person as a Pair partner, whose name, phone number, and other information need to be registered in the address book beforehand. Use the procedure under "Registering an Address Book" (page 41) to create the required record before trying to register a person as a Pair partner.



Your W52P supports two types of mail:
e-mail and C-mail.

Using E-mail

To use e-mail, EZweb subscription is required. If you did not subscribe when purchasing your phone, contact your nearest au shop or the au Customer Service Center.

In addition to EZweb subscription, an initialization procedure is needed before you can use e-mail. If you have not performed initialization yet, refer to “Initializing E-mail and EZweb” (page 23).

E-mail service allows you to exchange e-mail messages with other E-mail-enabled cellphones or e-mail addresses of PC.

You can send e-mail messages that contain up to 5,000 double-byte characters (10,000 single-byte characters), and you can attach photos and movies to e-mail messages.

▶ page 50

- ※ You can send an e-mail up to five addressees at a time.
- ※ You can send up to 1,000 e-mail messages (each addressee counts as a separate message) per day.
- ※ Sending and receiving operations may take longer when an e-mail message has attachment.
- ※ Sending and receiving mail requires a packet transmission fee according to the amount of data.

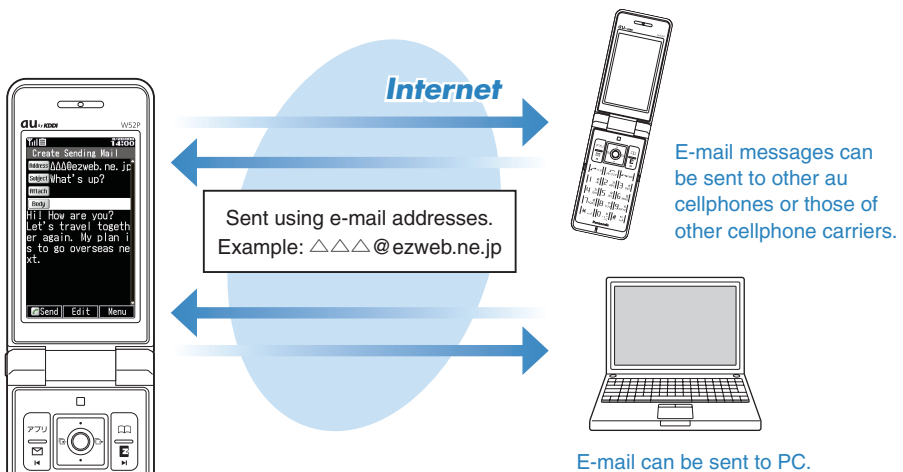

Using C-mail

C-mail service allows you to exchange text messages containing up to 50 double-byte characters (100 single-byte characters) with other C-mail-enabled au cellphones.

▶ page 56

※ C-mail sending fee is charged to send C-mail.



C-mail Center

To the recipient's phone number.
Example: 090-0001-XXXX

To your phone number.
Example: 090-0002-XXXX





C-mail can be sent to other C-mail-enabled au cellphones.

About C-mail Safety Block

- C-mail Safety Block blocks C-mails that contain accessing URLs (<http://△△△△>, <https://△△△△>) or phone numbers in their body texts. C-mail Safety Block is activated by default. If you want to receive C-mails containing accessing URLs or phone numbers in their body texts, you can deactivate this function.

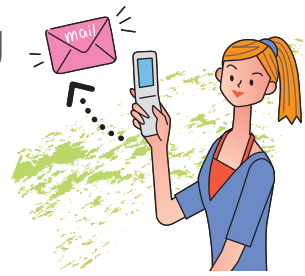
Creating and Sending E-mail Messages



1 While the standby screen is displayed, press , and press  (Create New).



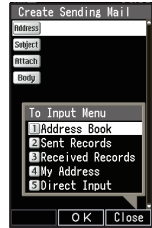
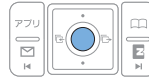

2 Select , and press  (Edit).





Address: Address to which the e-mail will be sent.

You can send an e-mail up to five addressees at a time.



3 Press  (Address Book), use  to select an addressee, and press  (Select).



You can select an addressee from sending records, receiving records, or My Address, or you can enter an address.

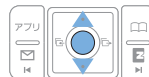

4 Use  to select the e-mail address you want to enter, and press  (OK).

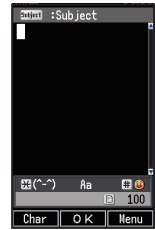
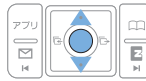

5 Use  to select **Subject**, and press  (Edit).



Subject: Subject of the e-mail message.

6 Enter the subject, and press  (OK).
Use  to select **Body**, and press  (Edit).

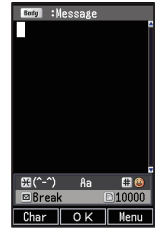
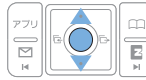



Body: Body of the e-mail message.

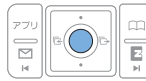

7 Enter the body text, and press  (OK).



8 Press  (Send) or .





The message “Sent.” appears on the display after the e-mail message is sent.



Reading Received E-mail Messages



When you receive an e-mail

“ E-Mail” and  appear on the standby screen.



Received e-mail icon





1 Select “ E-Mail”, and press  (OK).



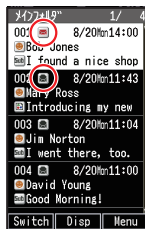
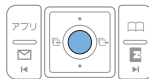

2 Press  (OK).

-  : Indicates an unread message.
-  : Indicates an already read message.



3 Use  to select the unread e-mail you want to view, and press  (Disp).

The received e-mail message appears. If all of the message cannot be displayed, press  to scroll.

Use  and  to scroll between messages.

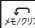
Press  to return to the e-mail message list.

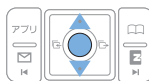



Info



You can also enable to show the received e-mail message by opening W52P.
 → “To set Open to Display New” (page 86)

Reading an E-mail Message with Attached Photos



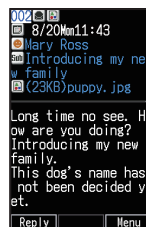
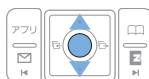

- 1** Use  to select the e-mail message, and press  (Disp).

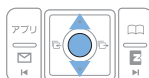

- 2** Use  to select a file name, and press  (Play).



Info

- ◎ Depending on the size, the photo file may not appear in step 2 of the procedure above. If this happens, select the file name, press , and .
- ◎ Sending and receiving operations may take longer when an e-mail message has attachment.
- ◎ Certain signal conditions may also cause slow work sending/receiving e-mails.

Replying to a Received E-mail Message



To reply to an e-mail message, perform steps 1 through 3 under “Reading Received E-mail Messages” (page 52), and perform the following steps.

1 Press  (Reply).



2 Press  (Edit), and enter the body text.

Subject is prefixed with “Re:”, and the body text of the e-mail is quoted.

For the remainder of this procedure

→Perform the procedure starting from step 7 under “Creating and Sending E-mail Messages” (page 50).

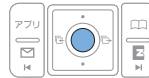

Avoiding Spam

It is recommended that you use our mail filter function to block spam.

You can activate mail filter easily using “Supportive settings” by answering questions that appear on the display.



■ Activating Mail Filter

Example: To access “サポート設定” (Supportive settings)

- ① While the standby screen is displayed, press .
- ② Press (E-Mail Setup) → (Mail Filter) → (Yes).
- ③ Use to select “次へ” and press (Select).
- ④ Enter your Security Code, press (OK).
→ Use to select “送信” and press (Select).

Next, follow the instructions that appear on the display.

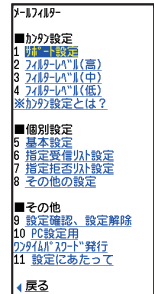

■ “カンタン設定” (Simple Settings)

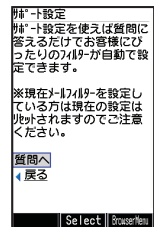

<p>“サポート設定” (Supportive settings)</p>	<p>You can choose filtering options by answering our questions. It is recommendable for those who want to check the filtering conditions one by one.</p>
<p>“フィルターレベル(高)” (Filter level (Strict))</p>	<p>You can block all the incoming mails from PC. It is recommendable for those who use only cellphones to send/receive e-mails.</p>
<p>“フィルターレベル(中)” (Filter level (Medium))</p>	<p>You can block the incoming e-mails containing “未承諾広告※” (Unsolicited advertisement) in their titles, and “なりすましメール” (Spoof e-mail), and e-mails from specified address. It is recommendable for those who are bothered by specified spam senders.</p>
<p>“フィルターレベル(低)” (Filter level (Normal))</p>	<p>You can block the incoming e-mails containing “未承諾広告※” (Unsolicited advertisement) in their titles, and “なりすましメール” (Spoof e-mail). It is recommendable for all e-mail users.</p>

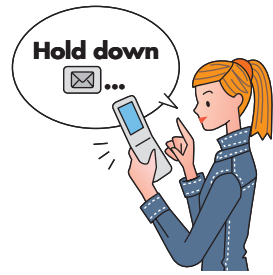

- ◎ You can prevent spam by changing your e-mail address. See “Changing Your E-mail Address” (page 25) for information about how to change your e-mail address.

Creating and Sending C-mail Messages



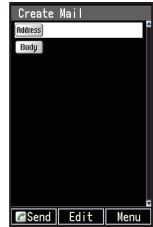

- 1** While the standby screen is displayed, hold down  for about one second, and press  (Create New).



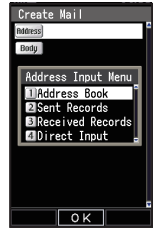
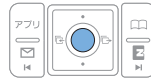

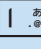
- 2** Select , and press  (Edit).



- 3** Press  (Address Book), use  to select an addressee, and press  (Select).



You can also select a phone number from sending/receiving records, or you can enter an address.

- 4** Use  to select the phone number you want to enter, and press  (OK).

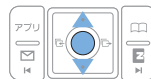

5 Use to select **Body**, and press (Edit). Enter the body text, and press (OK).



6 Press (Send) or (Reply).

When the C-mail reaches the other party, the message “Completed.” appears, and the message is stored in your sending records.



Reading Received C-mail Messages

When you receive a C-mail

“ C-Mail” and appear on the standby screen.

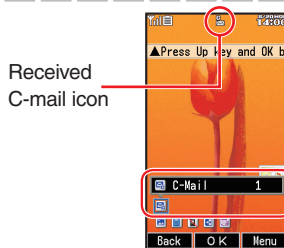

Mail

1 Select “ C-Mail”, and press (OK).

: Indicates an unread message.

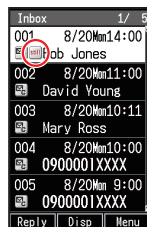

2 Use to select the unread C-mail you want to view, and press (Disp).

The received C-mail message appears. Use and to scroll between messages. Press to return to the C-mail message list.

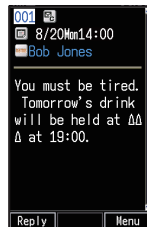
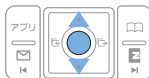

Info

You can also enable to show the received C-mail message by opening W52P.
→ “To set Open to Display New” (page 86)

Camera Features

Your W52P comes with a built-in 2.1-megapixel, 2.07-million effective pixel camera to shoot photos.

You can attach the photos that you shot to e-mail messages.

Using the Camera

1

Use your images for W52P functions!

You can use photos you shot for the standby screen, for the image that appears while the ring tone is sounding, and in your address book.



2

Send images by e-mail!

Within 500KB*, you can send a photo (shot with Mail Mode) as an e-mail attachment.

* Certain signal conditions may cause slow work sending/receiving e-mails.



Tips for Better Photos

Shooting Phone/Wallpaper size/ etc. Images

Do not cover the lens with your hands. Hold the camera securely with both hands.

Use your thumb to press  (Shutter) to release the shutter.

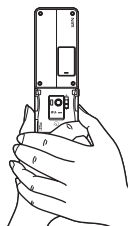

Shooting VGA/SXGA/UXGA/ WIDE size Images

Do not cover the lens with your hands. Hold the camera securely with both hands.

Use your thumb to press  (Shutter) to release the shutter.

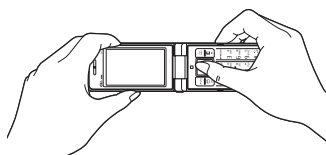

Tips for Avoiding Hand Movement

- Remain steady by keeping your arms lightly against your sides and standing with your legs spread apart to about shoulder level. Having your arms away from your side or extended in front of you can cause blurred images.
- When you press the shutter button, remain still until your shutter tone finishes sounding. This is especially important when shooting where lighting is dim.
- Self-timer is also available for shooting photos. With the self-timer, you do not need to press the shutter button to shoot a photo, so there is less chance of a blurred image caused by accidental movement of the phone.

Photo Sizes

The following shows the sizes of the photos that can be recorded with your W52P.



Photo sizes	Where to save		
Phone: 120×160	"Photo Folder" in W52P	①	
Wallpaper:※ 240×320		②	
WideWallpaper: 240×400		③	
VGA: 640×480	"Digicam Folder" in microSD™ Memory Card	④	
SXGA: 1280×960		⑤	
WIDE: 1600×960		⑥	
UXGA: 1600×1200		⑦	

※ The image sizes of Coupling Shot, Updown Shot and Serial Shot are same as that of "Wallpaper".

Camera

Shooting a Photo



- 1 While the standby screen is displayed, press , use  to select “camera”, and press  (OK).

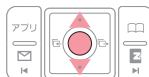

- 2 Press  (Photo).

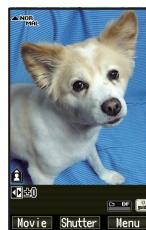

- 3 Point the lens at the subject, and press  (Shutter).

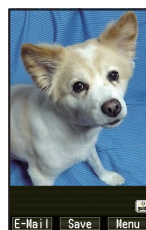

The phone emits a shutter sound.
Note that the phone emits the shutter sound even if Manner Mode is on.



- 4 Press  (Save).

The display shows the message “Saved to data folder (Phone).”, and returns to the photo monitor screen.

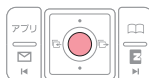
Photos you shot are saved to the “Photo Folder”, which is in the Data Folder.



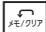

■ When You Fail in Shooting Good Photos

If the shot photo is not what you want, press  or  in step 4 of the procedure above.

Next, repeat step 3 to reshoot.

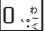
■ Displaying Key Help

While  (key help icon) is displayed in the lower right corner of the screen, press  to display key help.

Press  again to exit key help.

■ Meanings of the Photo Titles

The initial photo mode setting when you purchase your W52P is “Normal Shot (Wallpaper 240×320)”.

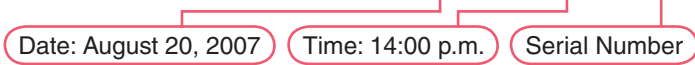

Meanings of the Photo Titles in the “Photo Folder”, which is in the Data Folder.

Example of a Photo Title 070820_1400~0001



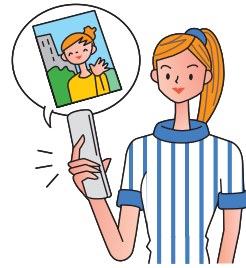

Viewing Photos



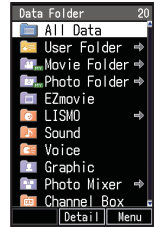
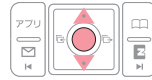

1 While the standby screen is displayed, press , use  to select “data folder”, and press  (OK).

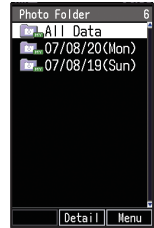
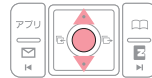

2 Use  to select “Photo Folder” and press  (Detail).



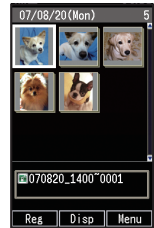
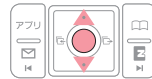

Selecting “All Data” displays a list of all photos in the “Photo Folder”.

3 Use  to select the dated (by recording date) folder, and press  (Detail).



A list of all photos that were saved that day are displayed.

4 Use  to select the photo you want to display, and press  (Disp).

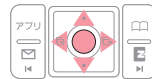

The photo displays.

Attaching a Photo to an E-mail Message

Perform the procedure from step 1 to 3 under “Shooting a Photo” (page 60), and perform the following steps.

1 Press  (E-Mail), and press  (Attach).

Photos you shot are saved to the “Photo Folder”, which is in the Data Folder.



2 Perform the procedure starting from step 2 under “Creating and Sending E-mail Messages” (page 50) to create an e-mail message.

EZweb

EZweb subscription required



Using EZweb

To use EZweb, EZweb subscription is required.

If you did not subscribe when purchasing your

phone, contact your nearest au shop or the au Customer Service Center.

In addition to EZweb subscription, an initialization procedure is needed before you can use EZweb. If you have not performed initialization yet, refer to “Initializing E-mail and EZweb” (page 23).

EZweb allows you to access to Chaku-Uta®, the latest news, and other web-based contents.

※ EZweb requires a packet transmission fee according to the amount of data you send and received. Connect time is not related.

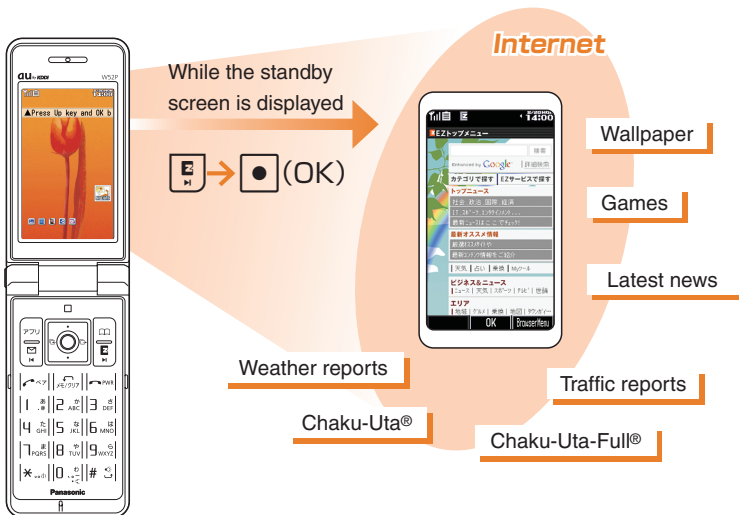

Displaying the EZ Top Menu

1 While the standby screen is displayed, press **[E]**, use **[←]** to select “EZweb”, and press **[1]** (Top Menu).

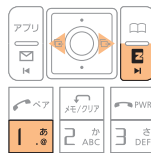

1	キーワード検索機能 (Search by keywords) Provides information search function by keywords
2	カテゴリで探す (Search by category) Searches for a site by category
3	EZサービスで探す (Search by useful EZ services) Introduces useful, amusing and recommended information services by EZweb
4	トップニュース (Top News) Provides the automatically-updating news
5	最新オススメ情報 (au recommending Information Updates) Introduces special features or contents updated in EZweb
6	デイリーツール (Daily Tool) Provides the daily information such as weather, fortunetelling, and useful information about transfer
7	ビジネス&ニュース (Business & News) Provides the latest information such as news, weather, share prices, and other information beneficial for business
8	エリア (Aria) Provides district information such as transfer or map
9	ショッピング&オークション (Shopping & Auctions) Provides information about shopping malls where you can purchase goods with your cellphone and the information about the net auction where you can sell or buy easily
10	ライフ (Daily life) Provides useful information for daily life
11	ホビー&カルチャー (Hobbies & Culture) Provides the latest information about games, fortunetelling, music, e-books, hobby and entertainment trends
12	コミュニティ (Community) Provides the useful, amusing information that make you feel like using such as SNS, blog
13	au My Page Provides the various information, useful tools, or large storage spaces, which are appropriate for your selection of the services
14	au style Introduces au-recommending information and sites
15	とくする情報 (Valuable Information) Provides gifts and useful information exclusively for EZweb service subscribers for free
16	auお客さまサポート (au Customer Support) Provides phone bills, procedures, au information, and au online manuals
17	カンタンアクセス・オープンサイト (Simple Access and Open Site) Introduces Simple Access and Open Site
18	災害用伝言板 (Disaster Message Board) To register/to check the safety information in disasters
19	ENGLISH Introduces English sites

Caution!

- ◎ The layout and contents of the EZweb screens are example. These are subject to change.
- ◎ Some sites may charge you for the content in addition to call charges.

Bookmarking Sites You Frequently Access



1 Display favorite sites you want to bookmark, and press  (BrowserMenu).

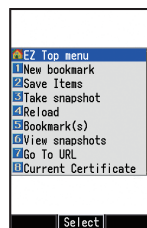



2 Press  (New bookmark).

※ You may not be able to bookmark some sites.



3 Press  (Reg.).



4 Use  to select a folder, and press  (OK).

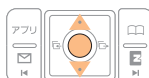

The message “Registered.” appears when completed.

Info

You can have up to 100 sites bookmarked in the Favorite Sites.

Viewing a Bookmarked Site





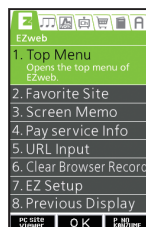

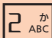
1 While the standby screen is displayed, press .



2 Use  to select “EZweb”, and press  (Favorite Site).



3 Use  to select a site or folder, and press .

If you selected a folder, use  to select a site, and press .



Downloading Chaku-Uta-Full® and Chaku-Uta®

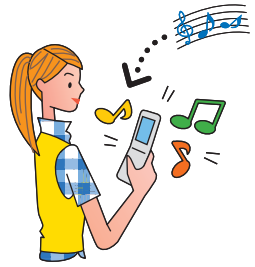

To download a Chaku-Uta-Full® or Chaku-Uta®, perform step 1 under “Displaying the EZ Top Menu” (page 65), and perform the following steps.

1 Use to select “カテゴリで探す” (Search by Category), and press (OK).

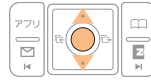

2 Use to select “着うたフル・ビデオクリップ” (Chaku-Uta-Full®/Video Clip) or “着うた” (Chaku-Uta®), and press (Select).

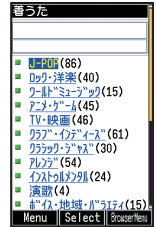
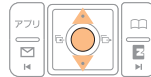

3 Select the content (desired information site), and download it.

In order to use fee-based contents, you need to enter your EZ password or premium EZ password. Default is the 4-digit number you entered on your subscription contract. Input the required password according to the instructions that appear on the display. The first time you use a site, register the password you want to use. To download information, follow the instructions that appear on the display. Downloaded data is stored in the Data Folder.

Caution!

In addition to call charges, you will be charged according to the pricing policy of each site to download Chaku-Uta-Full® or Chaku-Uta® and other contents from a fee-based site.



Info

Perform the same procedure to download wallpaper and use it for the standby screen background.

Checking Charges

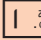
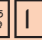

You can check call and transmission charges.

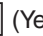

1 While the standby screen is displayed, press   あ  あ .

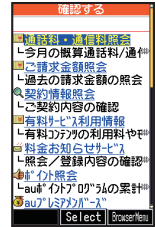
When the EZweb connection confirmation screen appears, press  あ  (Yes).



2 Use  to select the item you want to check, and press  (Select).

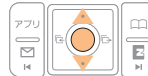

EZ Navi Features

EZweb subscription required

EZ Navi uses global positioning system (GPS) information to provide you with useful information.



Press .

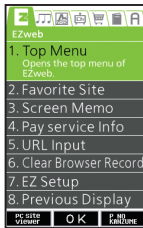

Use to select EZnavi".

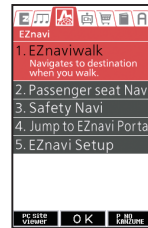

Checking your route: “EZ助手席ナビ” (Passenger seat Navi)



This service provides route information (by voice and map) to a person in passenger's seat.

When you check where your child is: “安心ナビ” (Safety Navi)



“Safety Navi” apps is composed of following three functions:

- “いつでも位置確認” (Auto Position Search) (paid)
- “位置確認メール” (Position Search Mail) (free)
- “エリア通知” (Area Message) (free)

You can check the location of an au cellphone supporting “Position Search” by operating W52P.

Alert mail is sent to a particular au phone whenever another phone enters (or is inside of) or exits (or is outside of) a preset area.

“EZnaviwalk”

A menu of useful options you can use while you are out.



ナビをする* (Navigation)	Searchable source of a route guidance (voice navigation) to your destination, shops, and facilities.
地図を見る (View Map) (free)*	You can view a map of your current location or any other location.
乗換検索する (Search Connection) (free)*	Searchable source of train transfer and timetable information.
道路情報を見る (View Traffic Info)	Check real-time traffic information on the major roads all over Japan.
もっとナビウォーク (EZ Navi Walk)	Provides explanations about each setting or search on PC.
インフォメーション (Information)	You can register for memberships or make inquiries.

The star symbol shows that you can use your voice to enter search terms. This is called “Voice input” function.

※ You are charged a fee for some services.

“View My Position”



Simply select View My Position to display your current location on a map in real time.

Your initial location is indicated by ★. Changes in your location are indicated in real time by 🚗.

“3D Navi”



The display is switched to the 3D image at the guidance point or a point near the destination.

Navigation engine by NAVITIME JAPAN
Map: Syobunsha Publications, Inc./Sumitomo Electric Industries, Ltd.

3D data: ZENRIN CO., LTD./GEO Technical Laboratory Co., Ltd.

Z06A-No.2137

Info



- ◎ When you use EZ Navi for the first time, perform the EZweb initialization procedure. If you have not performed initialization yet, refer to “Initializing E-mail and EZweb” (page 23).
- ◎ You will be charged packet transmission fee when you use various EZ Navi services. With some services, separate information fee may also be charged.
- ◎ The display layout and contents are examples. These are subject to change.
- ◎ Safety Navi services are available only among the cellphones supporting these feature.
- ◎ Before you can use Safety Navi, each other's cellphone number must be recorded in the address books of both of the cellphone.
- ◎ Before you can use Safety Navi, you need to agree the terms of use that appears the first time you start it up and you must register a password.
※ Agreement of the terms of use is required for both sides.
- ◎ The wrong location may be displayed in areas where GPS reception is poor, underground, inside of a building, or in areas surrounded by buildings.
- ◎ Area Message may not be able to send alerts properly in cases where correct location information cannot be obtained.
- ◎ When the other party is out of range, set to “reject”, no application, operating, or using a cellphone not supporting this service, you cannot check the location.
- ◎ This service becomes unavailable, when “The Use Suspension Course of Price Safety Service” is activated and the charges reach the upper limit.
- ◎ Safety Navi features cannot be used while C-mail is disabled.
- ◎ If “EZapps Rstr” has been set, you can use Safety Navi by releasing the restriction temporarily by inputting the Lock No. However, you will not be able to receive list registration messages or position search messages or start the area message specified time service.
- ◎ Free calling time provided by your service plans can be applied to EZ apps transmission charges. However, Family C-mail Service or Packet Transmission Discount Service does not apply to EZ apps transmission charges.
- ◎ In addition to the Packet transmission fee, information fee is charged for obtaining information or displaying map separately.

Simple Mode



Simple Mode lets you limit operations to the telephone function, address book, camera, e-mail, C-mail, EZweb, and other frequently used functions.

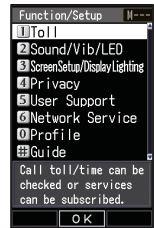
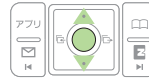

Entering Simple Mode

- 1 While the standby screen is displayed, press , use  to select "settings", and press  (OK).

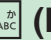

- 2 Press  (User Support),  (Operation Support), and  (Mode Setup).

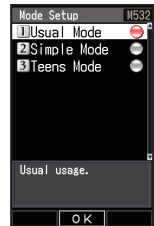

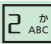
- 3 Press  (Simple Mode).





Info

- ◎ The lock No. is required when changing from Teens Mode to Simple Mode.
- ◎ When you enter Simple Mode, settings configured in Usual Mode are automatically changed to those configured in Simple Mode.

Exiting Simple Mode

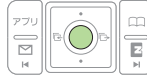
1 While the standby screen is displayed, press .



2 Use  to select "SETTINGS", and press  (Select).

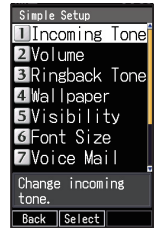
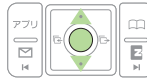

3 Press  (SimpleModeOFF).

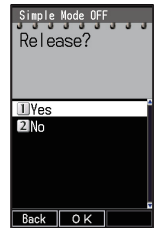

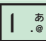
4 Press  (Yes).
This returns to Usual Mode.



Using the Simple Mode Main Menu

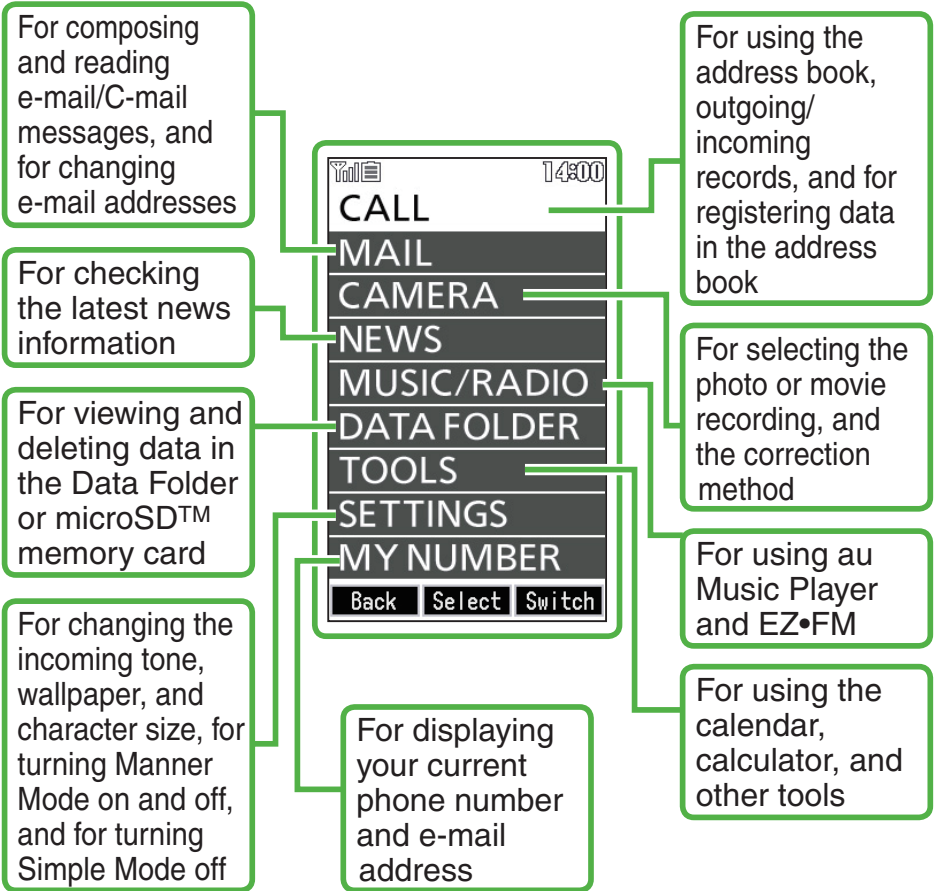

Info

Simple Mode has its own main menu.

You can switch between the two available Simple Mode main menu styles by pressing  (Switch).

Adding Data to the Address Book in Simple Mode



1 While the standby screen is displayed, press , press (Register), and press (Fix).



2 Enter the name, and press (OK).

To input text
→ “Inputting Characters” (page 37)

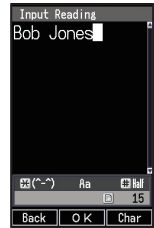

3 Check the reading of the name you inputted, press (OK), and press (Input by Myself).

You can also select data in incoming records or outgoing records. To go without saving the telephone number, press (Not Input) and perform step 5.



4 Enter the phone number, and press (OK).

When entering the number of a standard phone, be sure to start with the area code.



▶ Continued on the next page

5 Press (Input by Myself).

You can also select data in sending records or receiving records.
To go without saving e-mail address, press  (Not Input) and perform step 7.

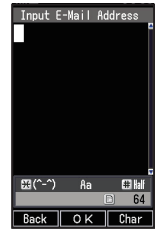

6 Enter the e-mail address, and press (OK).

To input an e-mail address
→ "Inputting an E-mail Address"
(page 38)



7 Press (Not Register).

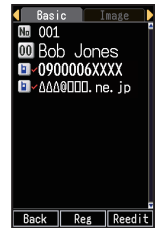

The confirmation screen appears.
Press  (OK).

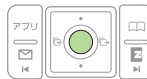

8 Press (Reg).



Info

- In Simple Mode, you can only input "Name", "Reading", "Phone Number1", "E-Mail Add1", and "Image" data into an address book record.
- You can press  (Register) in step 7 to select a photo in the Data Folder and assign it to the address book record.
- Pressing  (Reedit) in step 8, and pressing  (Change) returns to step 2 from which you can edit the contents of the record.



Using the Address Book in Simple Mode

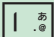

Example: To view a record in the address book



1 While the standby screen is displayed, press , and press  (Look).

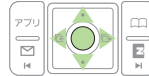

2 Use  to select the address book record you want to view, and press  (Select).

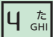

3 Press  (Read Data).

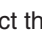
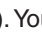
The address book record appears. Use  to select the phone number, and press  (Call). You can make a phone call. Use  to select the e-mail address, and press  (E-Mail). You can create an e-mail message.

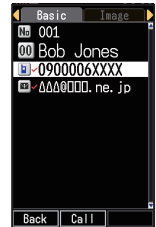



You can edit or delete records in the address book.

Creating and Sending E-mail Messages in Simple Mode

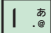
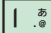

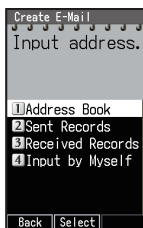

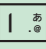
1 While the standby screen is displayed, press ,  (E-Mail), and  (Create Mail).

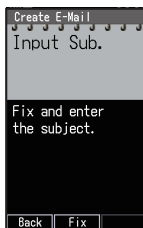

2 Press  (Address Book), use  to select an addressee, and press  (Select) twice.

You can select an address from sending/receiving records, or you can manually enter an address.



3 Press  (Fix), enter the subject, and press  (OK).

To input text
→ "Inputting Characters" (page 37)

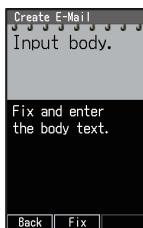

4 Press  (Fix).

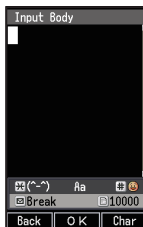

5 Enter the body text, and press (OK).

To input text
→ “Inputting Characters” (page 37)

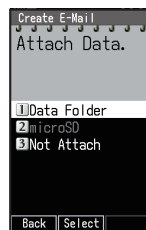

6 Press (Not Attach).

The confirmation screen appears.
Press  (OK).

In case of attaching some data with e-mail, operate the followings.

 (Data Folder):

You can select a photo saved in the Data Folder and attach it to the e-mail message.

 (microSD):

You can select a photo saved in the microSD™ memory card and attach it to the e-mail message.

In Simple Mode, an e-mail message can have only one attachment.

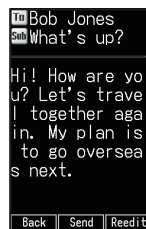



7 After checking the content of the e-mail, press (Send).

The message “E-Mail is sent.” appears on the display after the e-mail message is sent.





Info

Pressing  (Reedit) instead of  (Send) in step 7 returns to step 2, from which you can edit the contents of the e-mail message.

Shooting a Photo in Simple Mode



1 While the standby screen is displayed, press , use  to select “CAMERA”, and press  (Select).

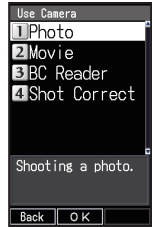
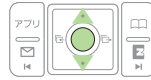



2 Press  (Photo), and press  (Photo1).

Photo 1	Wallpaper	240×320
Photo 2	WideWallpaper	240×400
Photo 3	VGA	1600×1200

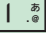

3 Point the lens at the subject, and press  (Shutter).

The phone will emit a shutter sound.

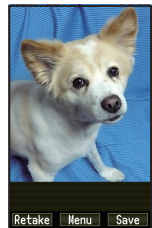

4 Press  (Save).



Info

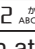

Pressing  (Menu) in step 4, and pressing  (Send Mail) will display a screen for composing an e-mail message with attached photo.

To create an e-mail message

→ Perform the procedure starting from step 2 under “Creating and Sending E-mail Messages in Simple Mode” (page 78).

Viewing Photos in Simple Mode



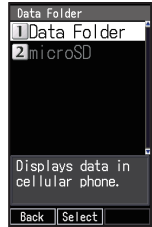
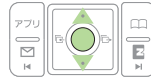

1 While the standby screen is displayed, press , use  to select “DATA FOLDER”, and press  (Select).

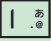

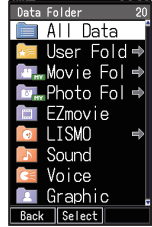

2 Press  (Data Folder).

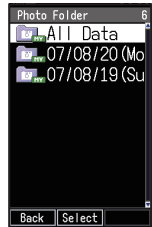
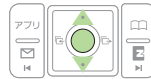

3 Use  to select “Photo Folder”, and press  (Select).

Selecting “All Data” displays a list of all photos in the Photo Folder.



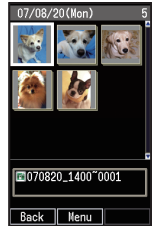
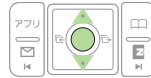

4 Use  to select the dated (by shooting date) folder, and press  (Select).

A list of all photos that were shot on that day are displayed.



Simple Mode

▶ Continued on the next page

5 Use  to select the photo you want to view, and press  (Menu).

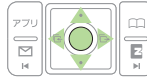

6 Press  (Play).

The photo appears.

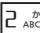

 (Delete): Deletes data.

 (Attach E-Mail): Displays a screen for composing an e-mail message with an attachment.

To create an e-mail message
 → Perform the procedure starting from step 2 under “Creating and Sending E-mail Messages in Simple Mode” (page 78).

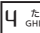
 (MoveTo microSD): Moves the data to microSD™ memory card.

 (Send via Ir): Sends your data via infrared.

Teens Mode



Teens Mode can be used to block spam, and to block inadvertent access to phone numbers and URLs included inside mail messages.

Teens Mode can also be used to restrict call time and the number of sending mail.

Using Teens Mode

Teens Mode can be used to restrict mail reception and display contents.

When the sender is a Pair partner	Receipt is allowed.
When the sender is included in the address book	Receipt is allowed. However, the phone numbers, e-mail addresses or URLs contained in the body of the mail message can not be used.
When the sender is not either of the above	E-mail: Only the sender's name and subject are received. (Body text and attached data are not received.) C-mail: Not received.

Turning on “Teens Restrict” and Teens Mode makes it possible to restrict call time and the number of sending mail.



● Making Calls

To someone who is a Pair partner	No restriction
To someone who is not a Pair partner	Call time is restricted. Further calling is not possible if the call time exceeds the “Teens Restrict” setting.

● Sending Mail Messages

To someone who is a Pair partner	No restriction
To someone who is not a Pair partner	The number of sendings is restricted. Further mailing is not possible if the number of sendings exceeds the “Teens Restrict” setting.

Activating Teens Mode

1 While the standby screen is displayed, press , use  to select “settings”, and press  (OK).

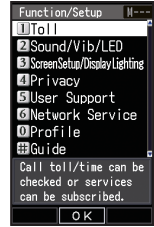
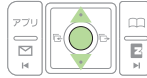

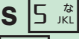
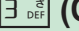

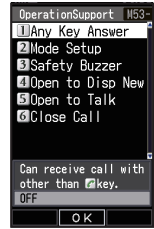
2 Press  (User Support), and  (OperationSupport).

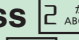
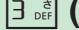

3 Press  (Mode Setup), and  (Teens Mode).



4 Press  (Switch Teens Mode), and enter the lock No., and press  (OK).



Info

The lock No. is required when changing from Teens Mode to Usual Mode or Simple Mode.







Other Functions

Safety Buzzer

Setting Safety Buzzer allows you to use W52P as high volume emergency buzzer by holding down  for about one second while the stand-by screen is displayed.

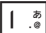

To turn on Safety Buzzer

While the standby screen is displayed, press    , and press  (ON). Input the lock No., and press  (OK).

To stop Safety Buzzer

To stop Safety Buzzer, input the lock No., and press  (OK).

※ You cannot turn off W52P or perform any other operation while the Safety Buzzer is sounding. The Safety Buzzer will continue to sound until you input the lock No. or the battery fully discharges.

Info

- ◎ While connected with Matsushita round-type earphone jack conversion adaptor 01 and MDR-E0931SP/BC by SONY/flat-type stereo earphone-microphone (option), Safety Buzzer sounds through W52P speaker.
- ◎ Even with Manner Mode set, Safety Buzzer Sounds.

In addition to the functions covered in this Basic Manual, your W52P also has the following features.

Global Expert

W52P supports Global Expert based on au IC-Card.

Global Expert is an international roaming service for the customers to use the phone replacing its au IC-Card with GSM cellphone for overseas use. No special application procedure or daily/monthly fee are needed, and the call charge is added up to domestic call, so the pay procedure is simple.

au Music

You can use au Music Player to enjoy a Chaku-Uta-Full® or your favorite CD tracks. Also, you can download a Chaku-Uta-Full® or purchase CD tracks by accessing "EZ Music!".

Barcode Reader & Maker

You can use the camera to read QR codes and barcodes. Also, you can create your own barcodes directly from your address book entries.

au My Page

You can upload and backup various data in your W52P (in Address Book, E-mail, Data Folder) to au My Page on server to manage/check them.

Infrared communication

You can exchange the data saved in your address book, Schedule, or Data Folder between au cellphones supporting infrared communication.

EZ FeliCa

Simply by holding W52P over reader/writer (external device), you can use W52P for shopping by using e-money or credit card or use it as member's cards, point cards, a discount coupon, and so on.

EZ•FM

The W52P allows you to listen to the FM radio.

Matsushita round-type earphone jack conversion adaptor 01 and MDR-E0931SP/BC by SONY have a built-in antenna to get a signal.

EZ apps (BREW®)

Enjoy downloaded games and other software.

PC Site Viewer

You can view the web sites just like those you view with your personal computer. You can comfortably view the web sites by high speed packet communication of 2.4 Mbps receiving at maximum.

Macro Mode (Photo and Movie)

Switching closeup switch allows you to take close-up photos of food, flowers, and other subjects (closest focusing distance: 10 cm).

Serial Shot (Photo)

You can shoot up to nine consecutive images and store all of them or only selected images in memory.

Recording a movie

You can record a movie. You can send a recorded movie as an e-mail attachment.

Post Recording/Telop (Movie)

After recording a movie, you can add audio or text. You can select 24 colors or 169 colors for text or background.

Hello Messenger

Using the characters of your choice, you can combine characters, sound and photos as desired, and hold conferences. Conferences with up to four people can be held.











EZ Channel-Plus / EZ Channel

Simply by registering the programs you want to view, the latest content will be delivered automatically so you can enjoy EZ programs just as you watch the TV or read a magazine.

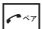
EZ News Flash

You can check latest news report on your standby screen. With this “information delivery service”, you can select EZ news flash telop or window to browse various news information.

Troubleshooting

Symptom	What to check	What to do	Page
The phone does not turn on. 	Is the battery pack installed correctly ?	Correctly install the battery pack.	—
	Is the battery pack charged ?	Charge the battery pack*.	P.12
	Are you holding down  for at least 1.5 seconds ?	Hold down  for at least 1.5 seconds to turn on the phone.	P.15
I can't make calls. 	Is h out (Out of Range) on the display ?	Wait until you are in a location where h out is not displayed before trying to make a call.	P.15
	Are you including the area code?	When making a call to a standard phone, you need to input the area code, and the phone number.	P.27
	Is the phone turned on?	Hold down  for at least 1.5 seconds to turn on the phone.	P.15
	Did you press  ?	After inputting the phone number, press  to dial it.	P.27
	Is Emission OFF Mode turned on?	Turn off Emission OFF Mode.	—
I can't receive calls.	Is h out (Out of Range) on the display?	Move to a location where h out is not on the display.	P.15
	Is the phone turned on?	Hold down  for at least 1.5 seconds to turn on the phone.	P.15
	Is Emission OFF Mode turned on?	Turn off Emission OFF Mode.	—
Nothing happens when I press the keys.	Is the phone turned on?	Hold down  for at least 1.5 seconds to turn the phone on.	P.15
The phone emits a warning tone, and turns off.	Is battery pack power low?	Charge the battery pack.	P.12
The phone answers calls automatically.	Is Easy Voice Memo turned on?	Hold down  for about one second to turn off Easy Voice Memo.	P.35
	Is Drive Mode turned on?	Hold down  for about one second to turn off Drive Mode.	P.4
I can't hear the caller.	Is the earpiece volume level too low?	During a call, press  to increase earpiece volume.	P.34
	Is the earpiece covered with your ear?	Make sure to place the earpiece to the center of your ear.	—

※ If the battery level is very low, when the phone is turned on, “Now loading” is shown on the display, and after a while display disappear.

For more detailed information, visit one of the following Panasonic websites.

- On your W52P, go to <http://www.pana-site.com/ez/> (P NO KANZUME). (Japanese only)
- On your PC, go to http://panasonic.co.jp/pmc/contact/cb_0001.html.

If you lose your W52P

Turning on Remote Auto Lock makes it possible for you to set Auto Lock and FeliCa Lock on from a remote location. These lock function keeps others from using your W52P.



■ Configuring Remote Auto Lock Settings

You can set Auto Lock and FeliCa Lock on by making calls several times from the registered phone number to your W52P within the specified period of time.

1 While the standby screen is displayed, press

● 4 た GHI 1 あ .あ DEF, input the lock No., and press ● (OK).

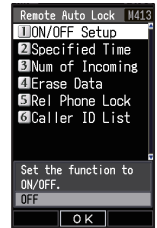

2 Press **6** は MNO (Caller ID List).

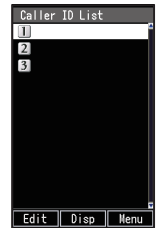

3 Use **▲▼** to select a registration number, press **アプリ** (Edit), input the phone number, and press ● (Reg).



You can also press **☰** (Menu) before inputting a phone number, and select the number from the address book, outgoing records, or incoming records, or you can specify a pay phone. You can register up to three different phone numbers.

Press **メモ/フリ** twice and advance to the next step.

4 Press **1** (ON/OFF Setup), and press **1** (ON).

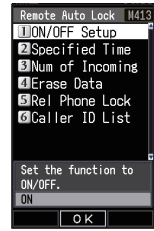

5 Press **2** (Specified Time), input the period you want to specify, and press **OK**.

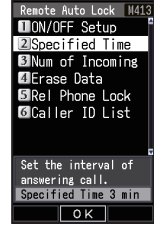

You can set the time period (the time intervals from the first call to the last call you should make to activate Remote Auto Lock). You can set the time period between 1 to 10 minutes.

6 Press **3** (Num of Incoming), input the number of calls you want to specify, and press **OK**.

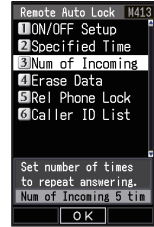

You can set how many times you should repeat making a call to activate Remote Auto Lock. You can set it from 3 to 10 calls.

■ Setting Auto Lock and FeliCa Lock on

1 Make a call to your W52P from the registered phone number within the period of time which has been specified in “Configuring Remote Auto Lock Settings” (page 90).

After repeating a call (3 to 10 calls you have specified), Remote Auto Lock turns active, and you hear an announcement letting you know Auto Lock and FeliCa Lock has been set. After Remote Auto Lock turns active, your W52P is automatically turned off, and turned on again.

Caution!

- Remote Auto Lock cannot be activated while your W52P is turned off or outside of the service area.
- When you purchase the W52P, its initial value in “Erase Data” setting is “Not Erase”, and its initial value in “Rel Phone Lock” setting is “Valid”.

Index

Sign

+Panel™ 14

A

Address Book..... 41

Adding outgoing or incoming record
data to the address book..... 44

Deleting 42

Dialing from the address book..... 45

Editing 43

Registering 41

Adjusting the earpiece volume

during a call..... 34

Adjusting the ring tone volume 33

Answering a call..... 29

au IC-Card..... 11

B

Basic Operations..... 19

Battery level..... 15

Battery pack..... 10, 11

C

Camera..... 58

Attaching a photo to an e-mail
message..... 63

Shooting a photo 60

Viewing photos 62

Chaku-Uta-Full® and Chaku-Uta®

Downloading..... 68

Changing the ring tone..... 31

Charging the battery 12

Checking charges 69

Checking your current phone number.. 24

C-mail 49

C-mail Safety Block 49

Creating and sending C-mail messages.. 56

Reading received C-mail messages.. 57

D

Desktop holder..... 10, 13

Disaster Message Board Service..... 6

Display indicators 20

Drive Mode..... 4

E

Earpiece volume..... 34

Easy Voice Memo 35

Delete 36

Playback 36

Turning on..... 35

E-mail 48

Avoiding Spam..... 55

Changing your e-mail address..... 25

Checking your current e-mail address.. 24

Creating and sending e-mail messages.. 50

E-mail Setup 55

Initializing e-mail 23

Reading an e-mail message with
attached photos..... 53

Reading received e-mail messages .. 52

Replying to a received e-mail message.. 54

EZ Navi 70

EZweb..... 64

Bookmarking sites 66

Downloading..... 68

EZ Password 68

EZ Top Menu 65

Viewing a bookmarked site..... 67

I

Incoming records..... 30

Initial settings (E-mail and EZweb).... 23

Initial values..... 15

Inputting characters..... 37

Inputting an e-mail address 38

Inputting pictographs 39

Inputting useful sentences..... 39

K

Key functions 19

M

Mail

C-mail 49

E-mail 48

Mail filter 5, 55

Main menu 21, 74

Making a call..... 27

Manner Mode..... 34

microSD™ memory card 11, 20

Mind your manners! 1

Missed call notification..... 29

N

Names of parts 11

Notify caller ID 27

O

One-push Open 12, 86

One-ring calls 5, 30

Other functions 85

Outgoing records 30

P

Pair Function 46

Making a phone call..... 47

Registering a Pair partner..... 46

Sending mail..... 47

Phone call 27

Photo

Sending a photo by e-mail 63

Shooting a photo 60

Viewing photos 62

Playback

Easy Voice Memo 36

Photo 62

R

Redialing (incoming/outgoing records) .. 30

Remote Auto Lock..... 90

S

Safety Buzzer..... 85

Safety Navi..... 70

Security Code 16

Signal strength..... 15

Simple Mode..... 72

Adding data to the address book..... 75

Creating and sending e-mail

messages..... 78

Entering Simple Mode 72

Exiting Simple Mode..... 73

Shooting a photo 80

Using the address book..... 77

Using the Main Menu..... 74

Viewing shot photos 81

Site..... 65, 66, 67

Soft keys 22

Spam 5, 55

Standby screen 15

T

Teens Mode..... 83

Troubleshooting 89

Turning Power On 15

U

Unsolicited advertisements 5, 55

Using Menus..... 22

V

Vibrator 34

For inquiries, call: au Customer Service Center

From EZweb site:

How to access

EZ→Top Menu→auお客さまサポート
(au Customer Support)
→お問い合わせ(Inquiries)



※Menu structure is subject to change without notice.

For general information and charges

From regular phones:

 **0077-7-111**
フリーコール (toll free)

From au cellphones:

157 area code not required
(toll free)

For loss, theft or damage and operation information

From regular phones:

 **0077-7-113**
フリーコール (toll free)

From au cellphones:

113 area code not required
(toll free)

Pressing "zero" will connect you to an operator,
after calling "157" on your au cellphone.



モバイル・リサイクル・ネットワーク

携帯電話・PHSのリサイクルにご協力を。

Cellphone and PHS operators collect and recycle unused telephones, batteries and battery chargers at stores bearing the  logo regardless of brand and manufacturer to protect the environment and reuse valuable resources.

Sales: KDDI Corporation
Okinawa Cellular Telephone
Company
Manufactured by Panasonic
Mobile Communications Co., Ltd

June 2007, 1st Edition

Read this to access to the
au online manual

